



SAFETY & INSTRUCTION MANUAL FOR TRADITIONS® SHEDHORN™



⚠ WARNING: YOU MUST READ THESE INSTRUCTIONS AND WARNINGS CAREFULLY. FAILURE TO READ THESE INSTRUCTIONS AND FOLLOW THESE WARNINGS MAY RESULT IN SERIOUS INJURY OR DEATH TO YOU AND OTHERS AND DAMAGE TO PROPERTY.

⚠ WARNING: Black Powder or an approved black powder substitute are the only propellant powders that are safe to use in this muzzleloading firearm.

This manual may not be reproduced in whole or in part without the express written permission of Traditions® Performance Firearms.

© 2023 Traditions® Performance Firearms. All Rights Reserved.

Traditions® Performance Firearms
1375 Boston Post Road
P.O. Box 776
Old Saybrook, CT 06475
(860) 388-4656
www.traditionsfirearms.com

FIT-85

02-23 AKH

Your Muzzleloading Firearm

Congratulations on your purchase of a Traditions® muzzleloader. You have selected a muzzleloading firearm designed and engineered to give today's shooters the highest performance and optimum accuracy. When given the respect and care that any firearm demands, you can expect many years of reliable service and enjoyable hunting from your new Traditions® muzzleloader.

The Sport of Muzzleloading

More and more people have discovered the challenge and enjoyment of muzzleloading in recent years. For both hunting and target shooting, muzzleloading firearms have helped a modern generation recapture and enjoy an important aspect of our nation's sporting past. Traditions® muzzleloaders represent the latest developments in this unique part of the shooting sports. They are manufactured to modern standards for safe and enjoyable shooting. This booklet is intended as a basic guide for the proper maintenance, loading and shooting of Traditions® muzzleloaders, and it offers important rules and precautions for safe handling and shooting of this firearm. In addition to this booklet, it is recommended that the novice obtain further information and instruction before firing a muzzleloader.

Sources for this help include:

1. National Rifle Association <https://home.nra.org/>
2. National Muzzleloading Rifle Association
3. Local sporting goods dealer, State DEP, or conservation department
4. Local muzzleloader or hunting club
5. National Shooting Sports Foundation
<https://www.nssf.org/>

⚠️ DANGER: Always keep your firearm pointed in a safe direction with your finger off the trigger until you are ready to fire. Never point a firearm at anything you do not intend to shoot and always be sure of what is beyond your target.

This SAFETY & INSTRUCTION MANUAL should always accompany this firearm and be transferred with it upon change of ownership or when the firearm is presented to another person.

If you don't have a manual, a printed copy is available free upon request by contacting Traditions® at the address below. A manual is also available via download at:

www.traditionsfirearms.com

BE SURE TO READ ANY ADDENDUMS THAT ARE INCLUDED IN THIS MANUAL AS THEY MAY PERTAIN TO YOUR MUZZLELOADER.

**• CUSTOMER SUPPORT •
Traditions® Performance Firearms
1375 Boston Post Road
P.O. Box 776
Old Saybrook, CT 06475
(860) 388-4656
www.traditionsfirearms.com**

TABLE OF CONTENTS

1. YOUR SAFETY RESPONSIBILITIES.....	5
2. SAFE STORAGE & TRANSPORTATION.....	10
3. SAFETY RULES.....	12
4. BASICS OF THE SHEDHORN™	15
5. SAFETIES ON SIDELOCKS.....	21
6. DOUBLE SET TRIGGER FUNCTION.....,	23
7. MAKING SURE YOUR FIREARM IS UNLOADED.....	24
8. INITIAL CLEANING.....	25
9. BASIC EQUIPMENT FOR SHOOTING.....	28
10. PREPARING TO CHARGE YOUR FIREARM.....	29
11. CHARGING THE SHEDHORN™	30
12. PRIMING THE SHEDHORN™	34
13. FIRING THE SHEDHORN™	35
14. DEPRIMING THE SHEDHORN™	36
15. DECOCKING IF YOU DON'T WANT TO FIRE.....	36
16. MISFIRES & HANGFIRES.....	37
17. UNLOADING THE SHEDHORN™	40
18. CLEANING & MAINTENANCE.....	42
19. DISASSEMBLY, DETAILED CLEANING & REASSEMBLY.....	44
20. INFORMATION ON BLACK POWDER & BLACK POWDER SUBSTITUTES	51
21. SUGGESTED LOADS FOR THE SHEDHORN™	54
22. SIGHTING IN WITH A SCOPE.....	56
23. SIGHTING IN WITH ADJUSTABLE SIGHTS.....	58
24. WARRANTY & SERVICE.....	59

1. YOUR SAFETY RESPONSIBILITIES

SAFETY IS YOUR NUMBER ONE RESPONSIBILITY!!!!

No matter if you are at home, in the field, at the range, or anywhere; your primary concern as a firearm owner must always be safety. You must always apply the following safety rules in every situation with any kind of firearm regardless of setting. If you feel unsure about any aspect of your firearm or its operation, please contact Traditions® before using it.

 WARNING: YOU MUST FOLLOW ALL OF THESE SAFETY RULES TO ENSURE THE SAFE USE OF YOUR FIREARM. THE FAILURE TO FOLLOW THE INSTRUCTIONS AND WARNINGS IN THIS MANUAL COULD CAUSE SERIOUS PERSONAL INJURY OR DEATH TO YOU OR OTHERS AND DAMAGE TO PROPERTY.

When you become a firearm owner, you take on a serious and demanding responsibility. How seriously you take this responsibility can be the difference between life and death. There is no excuse for reckless or abusive handling of your firearm. At all times you must handle your firearm with an intense respect for its power and potential danger.

 WARNING: YOU ARE RESPONSIBLE FOR THIS AND ALL YOUR FIREARMS AT ALL TIMES. In owning a firearm, you have a constant responsibility for your firearm's safety and security. You must always protect yourself and all others against injury or death from misuse of the firearm 24 hours a day, 7 days a week, 365 days a year. This responsibility is not something you can ever neglect.

 WARNING: ALWAYS BE SURE OF YOUR TARGET AND WHAT IS BEYOND IT. Always know where a projectile you fire will hit and shoot only where there is a safe back stop free of any obstructions. Projectiles can bounce or ricochet off many surfaces like rocks or the surface of water and travel in unpredictable directions with considerable velocity creating dangerous situations. NEVER fire randomly into the sky.

 WARNING: NEVER SOLELY RELY ON MECHANICAL FEATURES SUCH AS A SAFETY. Mechanical features such as safeties can fail and should never be relied upon with disregard to proper safe firearms handling. Only by following the safe firearms-handling procedures in this manual will the safe use of your firearm be assured. You are responsible for always following these safe firearm handling rules. Mechanical safeties in firearms are aides in establishing a more convenient operating system but are never replacements for safe handling on the part of the shooter.

⚠ WARNING: ALWAYS WEAR EYE AND EAR PROTECTION THAT ARE SPECIFIED FOR USE WITH FIREARMS every time you handle your firearm for loading, firing, cleaning, or maintenance. Make sure that all bystanders where you will be shooting are also wearing the proper eye and ear protection.

⚠ WARNING: ALWAYS HAVE ADEQUATE VENTILATION WHEN DISCHARGING A FIREARM. Discharging a firearm in poorly ventilated areas, cleaning firearms, or handling ammunition and loading components may result in exposure to lead and other substances known to cause birth defects, reproductive harm, and other serious physical injuries. Review the warnings and labels for all ammunition, loading components, and cleaning products carefully. Wash hands thoroughly after exposure.

⚠ WARNING: NEVER ALLOW THIS FIREARM TO BE USED BY ANYONE WHO DOES NOT UNDERSTAND ITS SAFE OPERATION OR HAS NOT READ THIS MANUAL IN ITS ENTIRETY.

⚠ WARNING: NEVER DISASSEMBLE YOUR FIREARM beyond the instructions outlined in this manual. Improper disassembly or re-assembly of your firearm may create a dangerous situation which can lead to serious injury or death to you or others or also the destruction of property.

⚠ WARNING: NEVER MANIPULATE, ADJUST, OR ALTER ANY OF THE INTERNAL COMPONENTS OF YOUR FIREARM. Improper manipulation or alteration of any internal component may affect the safety and reliability of your firearm and create a situation where serious injury or death could occur. In addition, do not replace any of the parts in your firearm unless they are genuine Traditions® parts. The use of non-Traditions® parts will void all warranties. Any alteration or replacement of parts in your Traditions® firearm not performed by a qualified gunsmith using genuine Traditions® parts may cause death, personal injury, or property damage. NOTE: Altering the factory-standard mechanical function of your firearm will VOID your warranty and could lead to unsafe handling and malfunction of the firearm.

⚠ WARNING! DO NOT DRILL HOLES IN THE BARREL AS THIS COULD WEAKEN THE BARREL STRUCTURE LEADING TO A RUPTURE. A RUPTURED BARREL CAN CAUSE SERIOUS INJURY AND/OR DEATH TO THE SHOOTER OR BYSTANDERS AND DAMAGE TO PROPERTY. DRILLING HOLES IN THE BARREL VOIDS ALL WARRANTIES.

⚠ DANGER: SAFE FIREARMS HANDLING IS YOUR PERSONAL RESPONSIBILITY ALWAYS. Firearms have the potential to be dangerous resulting in serious injury or death if they are misused or handled inappropriately. Safety must always be the primary concern of anyone who owns or handles firearms. Accidents are the result of violating the rules of safe firearm handling. Professional firearm safety training is available to supplement the safety instruction in this manual. Some examples of organizations to contact are your local firearms dealer, state conservation department, hunter safety department, law enforcement agency, local sportsman's club, the National Shooting Sports Foundation (NSSF), and the National Rifle Association (NRA) for availability of firearms training.

⚠ DANGER: ALWAYS TREAT EVERY FIREARM AS IF IT IS CHARGED AND WILL FIRE. Never assume or take anyone's word that the firearm is uncharged or unprimed - you must always physically check for yourself. Never pass a charged firearm to another person. You must check that it is uncharged and unprimed before passing the firearm to another person. Keep your muzzleloading firearm uncharged, unprimed, and safely stored when not in use.

⚠ DANGER: NEVER PLACE YOUR FINGER INSIDE THE TRIGGER GUARD OR ON THE TRIGGER UNLESS YOU INTEND TO FIRE. Always keep your finger off the trigger until your sights are on the target and you are prepared to fire. Also make sure that other objects do not touch the trigger at any time.

⚠ DANGER: ALWAYS KEEP YOUR FIREARM POINTED IN A SAFE DIRECTION. Never point the muzzle of a firearm at anyone or anything you do not intend to shoot. Many incidents have occurred because people pointed what they thought was an uncharged firearm in an unsafe direction. This is especially important when loading, unloading, or field stripping the gun. ALWAYS control the direction of the firearm.

⚠ DANGER: NEVER CROSS ANY OBSTACLES SUCH AS FENCES OR STREAMS WITH A CHARGED OR PRIMED MUZZLELOADING FIREARM. Always make sure your muzzleloading firearm is unprimed or uncharged before crossing a fence, climbing a tree, jumping a ditch, or negotiating any other obstacles.

⚠ DANGER: ALWAYS REMOVE THE MUSKET CAP FROM THE NIPPLE BEFORE YOU CLIMB TO OR DESCEND FROM A TREE STAND. NEVER RAISE OR LOWER A PRIMED MUZZLELOADER FIREARM TO OR FROM A TREESTAND. Failure to follow this rule may cause serious injury and/or death to the shooter or bystanders and damage to property.

⚠ DANGER: NEVER LEAN A CHARGED AND CAPPED FIREARM AGAINST A TREE, A WALL, OR ANY SURFACE WHERE IT MAY FALL OVER. Once a firearm has been charged or primed it is your responsibility to protect against any situation that may result in an accidental discharge. Failure to follow this rule may cause serious injury and/or death to the shooter or bystanders and damage to property.

⚠ DANGER: NEVER UNDER ANY CIRCUMSTANCES USE ALCOHOL OR DRUGS BEFORE OR WHILE SHOOTING. In addition, do not use your firearm if you are on any medication which impairs, even slightly, your mental or physical ability. You should also not use your firearm if you are excessively tired, distracted, or impaired in any way. You need to be alert and have your full attention devoted to the safe use of the firearm.

⚠ DANGER: ALWAYS USE THE CORRECT COMBINATION OF MUZZLELOADING APPROVED LOAD COMPONENTS FOR YOUR PARTICULAR MUZZLELOADING FIREARM as detailed in this manual.

⚠ DANGER: MAKE CERTAIN THE BARREL IS CLEAR OF ANY OBSTRUCTIONS BEFORE SHOOTING. Dirt, water, snow and other objects may inadvertently become lodged in the bore of the barrel. A small obstruction can cause a dangerous increase in pressure and may damage your firearm and cause injury or death. Refer to the field cleaning section of this manual if you discover any obstructions in the barrel for instructions on how to remove it.

⚠ CAUTION: BEFORE HANDLING ANY FIREARM, UNDERSTAND ITS OPERATION. Not all firearms are the same and some have features and mechanical operation unique to that specific firearm. Before using a firearm you should learn the mechanical features of that specific firearm you intend to use. If you feel unsure about any operational aspects of this firearm, please contact Traditions® before proceeding with its operation.

⚠ WARNING: This product can expose you to chemicals including lead, which is known to the State of California to cause cancer and birth defects or other reproductive harm. For more information go to www.P65Warnings.ca.gov.

APPROPRIATE USE FOR YOUR FIREARM MEANS USING YOUR FIREARM FOR LEGAL PURPOSES. It is your responsibility to ensure that you are in compliance with all applicable Federal, State, and Local laws and ordinances regarding the use of your firearm.

MAKE SURE THAT ALL SLINGS, SCOPES, AND ANY OTHER ACCESSORIES ARE COMPATIBLE with the firearm and that they do not interfere with the safe operation of the firearm. It is your responsibility to understand and follow all instructions in this manual, as well as those which may be supplied with your ammunition and loading components and any accessory and how they all relate to each other.

USE TRADITIONS® SCOPE MOUNTS ONLY. All current Traditions® rifles come drilled and tapped for use with scopes. Traditions® offers a wide variety of scopes, scope mounts, and rings in varying sizes and finishes to suit your needs. When mounting a scope use only Traditions® mounts to ensure proper fit and function. Traditions® mounts are specifically made to fit these predrilled existing holes in your firearm.

 **DANGER: BEFORE YOU ACCEPT A FIREARM FROM SOMEONE, CONFIRM FOR YOURSELF THAT IT IS UNCHARGED.** Treat all firearms as if they are charged and will fire.

 **DANGER: NEVER LEAVE A CHARGED FIREARM UNATTENDED.**

 **CAUTION: DO NOT ATTEMPT TO SHOOT OR LOAD YOUR FIREARM UNTIL YOU HAVE READ THIS MANUAL COMPLETELY AND FULLY UNDERSTAND IT. FAILURE TO READ AND FOLLOW THESE INSTRUCTIONS COULD RESULT IN INJURY AND/OR DEATH TO THE SHOOTER OR BYSTANDERS AND DAMAGE TO PROPERTY. IF YOU ARE UNABLE TO UNDERSTAND ANY OR ALL OF THIS MANUAL, CALL THE CUSTOMER SERVICE DEPARTMENT AT TRADITIONS®.**

2. SAFE STORAGE & TRANSPORTATION

 WARNING: FIREARM SECURITY IS YOUR PERSONAL RESPONSIBILITY. ALWAYS SAFELY STORE AND SECURE YOUR FIREARM. You must ensure that your firearms are securely and safely stored so that children and/or unauthorized users may not obtain them. Your firearms should always be kept uncharged and locked when not in use or in your immediate control. Never assume that the use of a lock alone is sufficient to safely secure your firearm. You must continually evaluate your personal situation and employ security systems that prevent children and unauthorized users from gaining access to your firearm. It is recommended that you secure bullets, loading components, and primers in a locked container separate from your firearms.

 WARNING: DO NOT PRIME UNTIL READY TO DISCHARGE YOUR FIREARM

 WARNING: FIREARMS ARE DANGEROUS IF THEY ARE USED AND/OR STORED IMPROPERLY. THEY POSE A RISK OF SERIOUS OR FATAL INJURIES. FIREARMS CAN BE ESPECIALLY DANGEROUS TO CHILDREN WHEN THEY ARE STORED IN AN IRRESPONSIBLE AND UNSAFE MANNER. FOR YOUR SAFETY AND THE SAFETY OF OTHERS, IT IS IMPERATIVE THAT YOU KEEP YOUR FIREARM LOCKED, UNCHARGED, AND UNPRIMED IN A SECURE PLACE. THE AMMUNITION AND LOADING COMPONENTS SHOULD BE STORED IN A SEPARATE, LOCKED, SECURE LOCATION WHEN NOT IN USE. SAFE AND SECURE STORAGE OF YOUR FIREARM IS ONE OF THE MOST IMPORTANT RULES OF FIREARM SAFETY. YOUR FAILURE TO FOLLOW THESE RULES MAY RESULT IN SERIOUS INJURY OR DEATH TO YOU OR OTHERS.

 WARNING: ALWAYS SECURE YOUR FIREARM IN A MANNER THAT WILL PREVENT UNAUTHORIZED ACCESS. Whenever you are not using your firearm it should be kept uncharged and locked. Your own safety and the safety of others demands that you always secure and store your firearm in a way that will prevent unauthorized access. Never leave a firearm unattended unless it is uncharged, unprimed, locked, and secured.

 WARNING: MAKE SURE TO CHECK TWICE THAT YOUR FIREARM IS UNCHARGED & UNPRIMED BEFORE TRYING TO INSTALL ANY LOCKING DEVICE.

⚠ WARNING: NEVER TRANSPORT A CHARGED OR PRIMED MUZZLELOADING FIREARM. When transporting your firearm it must be uncharged, unprimed and securely locked. Safe and secure transportation of your firearm is another important aspect of your responsibility as a firearm owner.

⚠ DANGER: NEVER STORE A CHARGED OR PRIMED MUZZLELOADING FIREARM. When storing your firearm it must be uncharged, unprimed and securely locked. If you fail to follow this instruction, you may experience a double load or fire the muzzleloader thinking it is uncharged.

⚠ CAUTION: ALWAYS STORE YOUR FIREARM AND AMMUNITION AND LOADING COMPONENTS SEPARATELY so that they are not accessible to children or other unauthorized persons. Safe and secure storage of your firearm, ammunition, and loading components is your responsibility.

⚠ CAUTION: NEVER ASSUME THAT A "SECRET LOCATION" OR "HIDING PLACE" IS A SECURE STORAGE METHOD. Without your knowledge others, such as children, may be aware of your storage location or they may find it by accident. It is your responsibility to properly store your firearms, ammunition, and loading components and to always make sure they are not accessible to children or unauthorized persons.

⚠ CAUTION: ALWAYS FOLLOW THE LAW! In many states and local municipalities there are laws and regulations that make it a crime to keep a firearm unlocked in an area that is accessible to children or others. Keeping a firearm locked and uncharged when not in use is not only a common sense safety practice... IT IS THE LAW. You must be familiar with all local, state, and federal laws regarding the safe storage and transportation of your firearm. Failure to know and follow the law may result in unauthorized access or use of your firearm by another for which you may be held accountable. Obey all laws relating to the storage and transportation of firearms. Your local police department or gun shop can provide you with the pertinent information for where you live on storing and/or transporting a firearm safely and legally.

3. SAFETY RULES FOR YOUR TRADITIONS® MUZZLELOADER

In addition to the general Firearm Safety Responsibilities covered so far in this manual, there are additional guidelines specific to black powder muzzleloading firearms that must be adhered to at all times to ensure the safety of the shooter and others.

 **WARNING: UNDERSTAND THE TERMINOLOGY REGARDING LOADING.** When speaking of a ShedHorn™ muzzleloading firearm “Charge” or “Charged” refers to the presence of a propellant powder charge and projectile in the bore of the firearm.

“Uncharge” or “Uncharged” indicates that the powder charge and projectile have been either fired or removed and that the bore is completely clear.

“Prime” or “Primed” applies to the act of placing a musket cap on the nipple.

“Unprime” or “Unprimed” indicates that the musket cap has been removed from the firearm or is not in place.

 **DANGER: NEVER UNDER ANY CIRCUMSTANCE USE SMOKELESS POWDER OF ANY TYPE OR IN ANY QUANTITY IN A MUZZLELOADING FIREARM, AND NEVER MIX POWDERS.** The use of any smokeless powder at all could result in a detonation or explosion which could cause injury and/or death to the shooter or bystanders and damage to property.

 **DANGER: NEVER USE ANY POWDER THAT YOU CANNOT POSITIVELY IDENTIFY.** The use of any mislabeled or unknown powder could result in injury and/or death to the shooter or bystanders and damage to property.

 **DANGER: USE ONLY BLACK POWDER OR AN APPROVED BLACK POWDER SUBSTITUTE IN YOUR TRADITIONS® MUZZLELOADING FIREARM.** Never use even small amounts of smokeless powder, even if it may be black in color. The use of any propellant other than black powder or approved black powder substitute may cause injury or death to the shooter or bystanders and damage to property.

 **DANGER: USE ONLY HIGH QUALITY FACTORY PROJECTILES WHICH MATCHES THE CALIBER DESIGNATION ON YOUR FIREARM BARREL.**

 **DANGER: NEVER SMOKE OR ALLOW BYSTANDERS TO SMOKE WHILE USING YOUR MUZZLELOADER.** The spark from a lighted cigarette, cigar, or pipe can ignite Black Powder or a Black Powder substitute, or Caps. Smoking around a charged and/or primed muzzleloader, supply of caps, or supply of powder may cause premature firing of the firearm or an explosion causing serious injury and/or death to the shooter or bystanders and damage to property.

 **DANGER: DO NOT LOAD A MUZZLELOADER WHICH IS HOT FROM PREVIOUS FIRING. ALWAYS ALLOW THE BARREL TO COOL BEFORE YOU BEGIN RELOADING YOUR MUZZLELOADING FIREARM.**

 **DANGER: BEFORE YOU BEGIN LOADING, MAKE SURE YOUR MUZZLELOADING FIREARM IS NOT ALREADY CHARGED. SEE PAGE 24 FOR THIS PROCESS.**

 **DANGER: WHEN LOADING, MAKE SURE THAT THE PROJECTILE IS FIRMLY SEATED AGAINST THE POWDER CHARGE.** Serious personal injury or death can result if the projectile is not seated properly against the powder charge. A simple way to check this when loading is after you have fully seated a projectile against a powder charge mark the ramrod as a point of reference for a properly seated projectile.

 **DANGER: NEVER EXCEED THE RECOMMENDED MAXIMUM BLACK POWDER OR BLACK POWDER SUBSTITUTE CHARGE LISTED IN THIS BOOK.** If the recommended maximum charge is exceeded then injury or death to the shooter or bystanders can occur.

 **DANGER: NEVER POUND ON THE RAMROD WHEN LOADING.** Black powder and/or approved black powder substitutes are potentially sensitive to impact and could ignite from the impact of pounding on the ramrod. Always be sure to keep the muzzle pointed away from your face or body when loading. Place your fingers and hand around the ramrod, and not over the end of the ramrod when seating the projectile for safety.

 **DANGER: NEVER PRIME YOUR MUZZLELOADING FIREARM UNTIL YOU ARE READY TO FIRE IT.** Your muzzleloader should remain unprimed until firing is imminent. After you prime the firearm, your full attention should be on the target and firing of the firearm.

⚠ DANGER: NEVER PASS A PRIMED MUZZLELOADING FIREARM TO ANOTHER PERSON. Once primed, a muzzleloading firearm requires your complete attention. Never prime the firearm and then hand it to another shooter. You should also never shoot a muzzleloading firearm that was primed by someone else. Only the person who actually performed the loading knows whether the firearm has been primed and charged properly and should fire it.

⚠ DANGER: BEFORE YOU ACCEPT A MUZZLELOADING FIREARM FROM SOMEONE, CONFIRM FOR YOURSELF THAT IT IS UNPRIMED, UNCHARGED, AND CONTAINS NO PROJECTILE. Treat all firearms as if they are charged and will fire.

⚠ DANGER: NEVER CHARGE YOUR MUZZLELOADER DIRECTLY FROM A CAN, HORN OR FLASK. A spark from a previous firing may ignite the stream of powder being poured into the firearm and cause the container to explode. The explosion of a powder can, horn or flask may cause serious injury and/or death to the shooter or bystanders and damage to property. Use a separate pre-calibrated measuring device containing small quantities of powder to charge your firearm. Keep the muzzle directed away from your face and body when loading.

⚠ DANGER: WHILE SHOOTING ALWAYS KEEP SUPPLIES OF POWDER AND CAPS WELL AWAY FROM YOUR FIRING POSITION OR SHOOTING BENCH. A powder horn, flask, can of powder, or quantity of caps can ignite with deadly force if exposed to sparks or intense heat. Follow the manufacturer's instructions for safe handling and storage of powder or caps. Keep unused powder and caps well away from firearms that are being discharged. Sparks from the discharge of a muzzleloading firearm may cause the unused supply of powder or caps to ignite causing serious injury and/or death to the shooter or bystanders and damage to property.

⚠ CAUTION: BLACK POWDER AND BLACK POWDER SUBSTITUTES ARE CORROSIVE BY NATURE AND MAY LEAVE RESIDUES IN THE BORE AND ON THE FIREARM THAT REQUIRE IMMEDIATE CLEANING. A quick field cleaning should be performed just after you complete firing at the range or hunting. A thorough in depth cleaning is required before storage for any amount of time to keep the firearm functioning properly and in a safe condition. Failure to properly clean the firearm may prevent the firearm from functioning safely and correctly and may result in injury or death to the shooter or bystanders and damage to property.

You must follow these procedures every time a firearm leaves your hand, is cleaned, handed to you or another person, transported or stored.

4. LEARNING THE BASICS OF THE SHEDHORN™

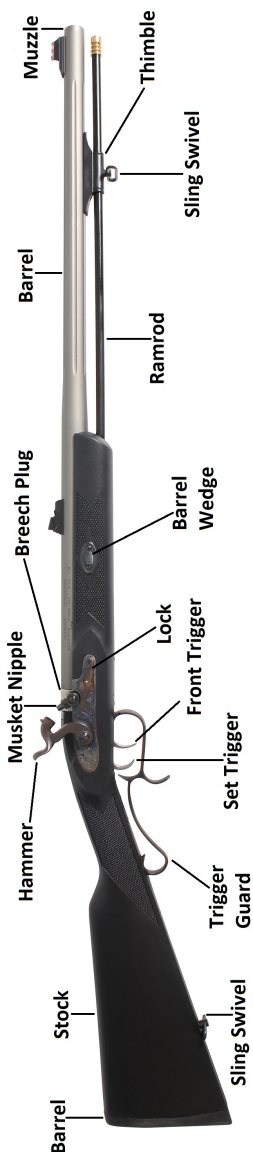
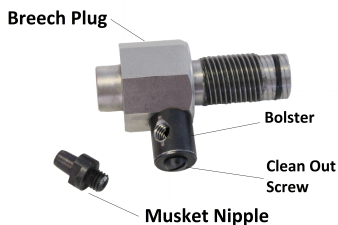

Please note your model may differ from the features you see here.

Serial Number Marking On Barrel



Propellant Marking On Barrel

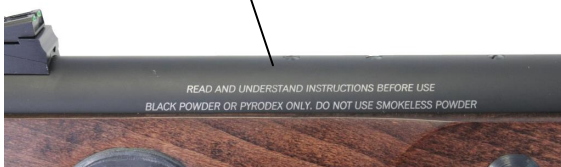

Caliber Designation On Barrel



ShedHorn™ Synthetic Stock / Double Set Trigger

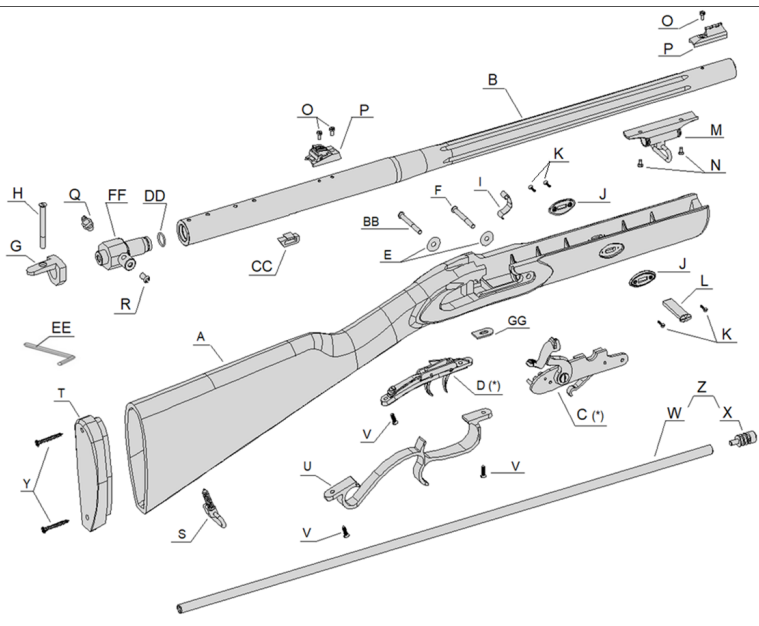

Letter	Description	Reference
A	Stock (AW Synthetic) (Finished)	FCS39001
B	26" SS CeraKote Barrel .50 Cal. Percussion Lock (Twist 1-28") (Finished)	FB391080
C	Percussion Lock	20903
D	Trigger Assembly	20622R-1
E	Lock Plate Washer (2 Units)	22819
F	Lock Plate Screw (Front)	20620
G	Barrel Tang	38006
H	Tang Screw	20841
I	Ramrod Retaining Spring	20621
J	Stock Plate (2 Units)	36016
K	Stock Plate Screw (4 Units)	36017
L	Barrel Wedge	22218-4
M	Ramrod Thimble/Rib/Swivel	36013
N	Thimble/Rib Screw (2 Units)	73621

Letter	Description	Reference
O	Sight Mounting Screw (3 Units)	73620
P	Metal Williams Sights Assembly	70288
Q	Musket Nipple	600608
R	Bolster Screw	20605
S	Stock Sling Swivel	25046
T	Buttpad	38126
U	Trigger Guard (Blackened)	21823
V	Trigger Guard Screw (3 Units)	730011
W	Ramrod (Aluminum)	610030
X	Ramrod Tip .50 cal	600028
Y	Buttpad Mounting Screw (2 Units)	20634
Z	Ramrod Assembly	610011
BB	Lock Plate Screw (Rear)	20221
CC	Barrel Tenon	20533
DD	Rubber O-Ring	70016
EE	Allen Wrench	M38005
FF	Octagonal Speed Breech	3900099
GG	Trigger Guard Supplement	39102

ShedHorn™

Select Hardwoods Stock / Double Set Trigger

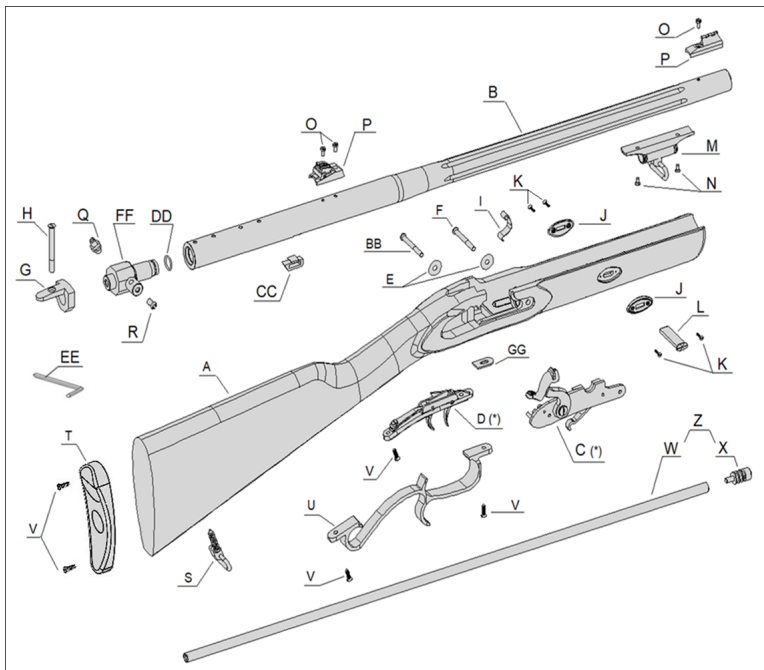

Letter	Description	Reference	Letter	Description	Reference
A	Stock (Select Hardwoods) (Finished)	FCS39003	P	Metal Williams Sights Assembly	70288
B	26" Black CeraKote Barrel .50 Cal. Percussion Lock (Twist 1-28") (Finished)	FB392080	Q	Musket Nipple	600608
C	Percussion Lock	20903	R	Bolster Screw	20605
D	Trigger Assembly	20622R-1	S	Stock Sling Swivel	25046
E	Lock Plate Washer (2 Units)	22819	T	Buttpad	48026
F	Lock Plate Screw (Front)	20620	U	Trigger Guard (Blackened)	21823
G	Barrel Tang	38006	V	Trigger Guard & Buttpad Mounting Screw (5 pcs)	730011
H	Tang Screw	20841	W	Ramrod (Aluminum)	610030
I	Ramrod Retaining Spring	20621	X	Ramrod Tip .50 cal	600028
J	Stock Plate (2 Units)	36016	Z	Ramrod Assembly	610011
K	Stock Plate Screw (4 Units)	36017	BB	Lock Plate Screw (Rear)	20221
L	Barrel Wedge	22218-4	CC	Barrel Tenon	20533
M	Ramrod Thimble/Rib/Swivel	36013	DD	Rubber O-Ring	70016
N	Thimble/Rib Screw (2 Units)	73621	EE	Allen Wrench	M38005
O	Sight Mounting Screw (3 Units)	73620	FF	Octagonal Speed Breech	3900099
			GG	Trigger Guard Supplement	39102

Percussion Lock Assembly - Ref. 20903

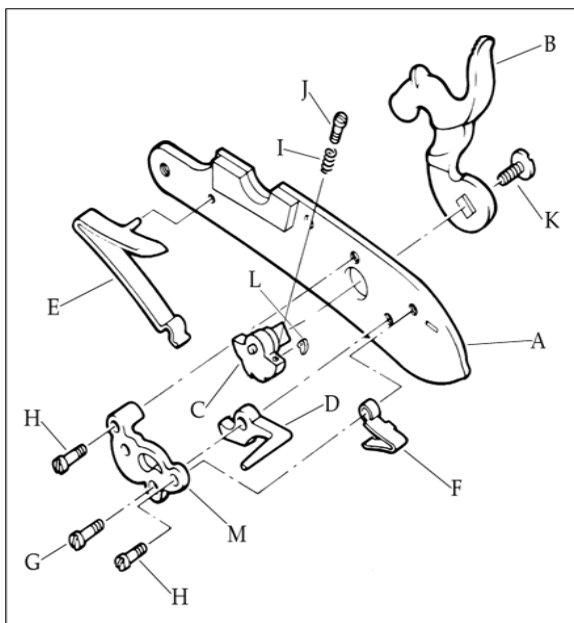

Letter	Description	Reference
A	Lock Plate	70501
B	Hammer	38024
C	Tumbler	70603
D	Sear	70504
E	Mainspring	70505
F	Sear Spring	70506
G	Sear Screw	70514
H	Sear Spring & Bridle Screw (2 units)	70515
I	Sear Adjusting Screw Spring	70520
J	Sear Adjusting Screw	70518
K	Hammer Screw	75512P
L	Fly	70611
M	Bridle	70508

Trigger Assembly - Ref. 20622R-1

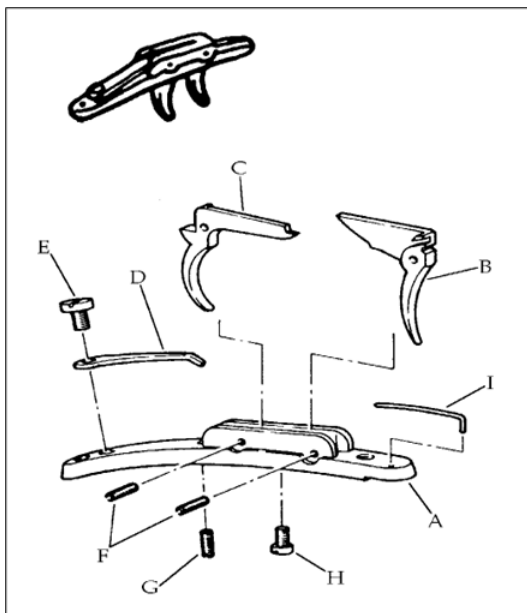

Letter	Description	Reference
A	Trigger Plate	60601R-1
B	Front Trigger	60602
C	Rear Trigger	60603
D	Rear Spring	60604R
E	Rear Spring Screw	60606
F	Trigger Pin (2 Units)	60609
G	Rear Trigger Adjustment Screw	60608
H	Front Trigger Adjustment Screw	60607
I	Front Spring	60605

5. SAFETIES INCLUDED ON SIDELOCKS

Your Traditions® sidelock muzzleloader comes equipped with half cock safety on the fire control system. This is where the hammer's forward rotation is arrested into a recess on the tumbler, not allowing it to fall forward without rotating the hammer back to full cocking position and pulling the trigger. The trigger will also be arrested at half-cock position and will not pivot if pulled.



PROPER HALF-COCK SEAR POSITION



IMPROPER HALF-COCK SEAR POSITION



PROPER FULL-COCK SEAR POSITION



IMPROPER FULL-COCK SEAR POSITION

⚠ DANGER: IF YOUR HAMMER IS NOT FUNCTIONING PROPERLY DO NOT CONTINUE TO USE YOUR FIREARM. CONTACT A GUNSMITH OR TRADITIONS® CUSTOMER SERVICE DEPARTMENT FOR ASSISTANCE.

HAMMER POSITIONS ON THE SHEDHORN™

At Rest



Half Cock



Full Cock



6. DOUBLE SET TRIGGER ON SHEDHORN™

The purpose of a double set trigger is to increase the sensitivity of the front trigger. The front trigger actually fires the gun. Double set trigger systems are used during bench, precision target shooting and hunting.

⚠ WARNING: THE TRIGGERS ON THE SHEDHORN™ ARE SET AT THE FACTORY AND ARE NOT ADJUSTABLE.

DOUBLE SET TRIGGERS OPERATION

⚠ WARNING: CONFIRM THAT THE FIREARM IS UNCHARGED AND UNPRIMED BEFORE TESTING THE TRIGGER OPERATION.

⚠ WARNING: ALWAYS KEEP THE FIREARM POINTED IN A SAFE DIRECTION. TREAT EVERY FIREARM AS IF IT WERE CHARGED AND CAN FIRE.

1. With the firearm pointed in a safe direction, place hammer in the half-cock position. Set (pull) the rear trigger until it clicks into position. With the hammer in the half-cock position, it should be impossible to make the hammer fall by applying pressure on the front trigger or pushing the hammer forward.



2. Place the hammer in the full cock position. Set the rear trigger. Test that it will stay in this position by attempting to push the hammer forward. With the hammer secure, apply light pressure to the front trigger so the firearm will then fire.



⚠ DANGER: IF THE LOCK AND TRIGGERS DO NOT PERFORM AS INTENDED, DO NOT CONTINUE UNTIL THIS PROBLEM HAS BEEN CORRECTED. CONTRACT TRADITIONS® CUSTOMER SERVICE DEPARTMENT FOR ASSISTANCE.

7. CHECKING THAT YOUR SHEDHORN™ IS UNLOADED & UNPRIMED

 DANGER: ALWAYS POINT THE MUZZLE IN A SAFE DIRECTION AND DO NOT HAVE ANY PART OF YOUR BODY OVER THE MUZZLE WHEN LOADING.

Prior to loading, cleaning or storing, you must ensure that the firearm is uncharged, unprimed, and the barrel is free of any obstructions.

 WARNING: WEAR PROPER EYE PROTECTION AT ALL TIMES.

Checking Your Firearm Is Unloaded

1. Remove the ramrod from the thimbles.
2. Insert the ramrod into the barrel. When it is touching the top of the breech plug it should sit approximately 1" above the muzzle.

Note: You should hear a metallic sound as the jag makes contact with the breech plug.

If you do not hear the metallic sound then the barrel may be either obstructed or charged. To remove the obstruction or the charge, disassemble the firearm following the disassembly procedures outlined in this manual. Do not attempt to clear the barrel by firing. Before loading anything into the barrel, clean all oil and grease from inside the barrel. We recommend using Traditions® cleaning products to enhance your accuracy and ease shooting & cleaning.

3. Once you have determined your firearm is unloaded, mark the ramrod with a knife or some sort of instrument that will remain permanent. This will allow you to easily see if your firearm is unloaded in the future.

Checking Your Firearm Is Unprimed

1. Check to be sure the hammer is in the half cock position.
2. Visually inspect the nipple to see if a cap is installed.
3. If a new or spent cap is in place, remove it to de-prime the firearm.

8. INITIAL CLEANING OF THE SHEDHORN™

⚠ WARNING: CONFIRM THAT THE FIREARM IS UNCHARGED AND UNPRIMED BEFORE PERFORMING ANY CLEANING.

⚠ WARNING: WHEN PERFORMING THE INITIAL CLEANING ALWAYS KEEP THE FIREARM POINTED IN A SAFE DIRECTION. TREAT EVERY FIREARM AS IF IT WERE CHARGED AND CAN FIRE.

NOTE: BEFORE YOUR INITIAL USE CLEAN AND LUBRICATE YOUR SHEDHORN™!

These are brief instructions on what to do before you use your ShedHorn™ for the first time. Please review the disassembly instructions on page 44 for the complete set of cleaning instructions. When you remove your new ShedHorn™ from the box there may be residues that need to be removed before shooting.

1. Place the hammer in the half cock position.
2. Remove the ramrod from the thimbles.
3. Carefully remove the barrel wedge through the lock side of the firearm by using a wedge puller or a non-marring punch with a rubber mallet.



4. Loosen both lock plate screws with a flat head screwdriver. Take caution not to fully remove the lock plate screws. If the front lock plate screw is removed, the ramrod retaining spring will be detached from the screw and will require re-installation. While you will remove these during a detailed cleaning, it is not necessary for the initial cleaning. If you do remove the front lock plate screw and the ramrod retaining spring see page 44 for installation instructions.



5. Loosen the tang screw with a flat head screwdriver.



6. Lift the barrel up slightly and then pull it straight out of the stock. You may need to twist the barrel slightly to pull the barrel away from the tang. If the tang screw is not loose enough or if there is too much upward pressure when lifting the barrel, this can bend or break the tang.



⚠ WARNING: IMPROPER REMOVAL OF THE BARREL WILL DAMAGE THE TANG AND IS NOT COVERED UNDER WARRANTY.

7. Grasp the barrel in one hand and use the other hand to rotate the breech plug counter clockwise to remove from the barrel.



If the breech plug is difficult to remove:

A. Place the barrel in a padded vice to allow for better leverage and use a 6mm Allen wrench to remove the breech plug. Insert the post of the wrench into the hex socket in the back of the breech plug and turn the handle counter clockwise. OR

B. Spray penetrating oil down the muzzle of the barrel and let sit for one hour.

NOTE: You do not need to remove the nipple or clean out screw for the initial cleaning.

8. Clean all items with hot, soapy water or muzzleloader bore solvent such as Traditions® EZClean2®. This will remove any manufacturing residue that may be on the inside or outside of the barrel.
9. Dry all parts completely.
10. Apply a light coat of Traditions® EZClean2® solvent to a dry patch (or use Traditions® pre-saturated EZClean2® patches). Install a cleaning jag on your ramrod and place the patch over the jag. Run the patch up and down the bore.



11. Use the Traditions® Cleaning & Seasoning Patches to "season" the lands and grooves of the rifling before loading. This will allow for easier loading and cleaning throughout your shooting sessions.



12. Generously lubricate the threads of the breech plug with Traditions® breech plug grease. Be careful to not get any grease inside the breech plug.
13. Now reassemble your firearm. For help with reassembly, see page 44.

A Note about maintenance procedures:

Proper maintenance and cleaning of your new muzzleloader will require you to follow the cleaning instructions in this manual. You must clean the muzzleloader each time it is used.

Please refer to the Cleaning & Maintenance section for more information. Take time before such cleaning to study the Disassembly/Assembly procedures and the accompanying photographs to thoroughly acquaint yourself with your muzzleloader's subassemblies.

9. BASIC EQUIPMENT FOR SHOOTING SHEDHORN™

 CAUTION: DO NOT ATTEMPT TO FIRE OR LOAD YOUR MUZZLELOADING FIREARM UNTIL YOU HAVE READ THIS MANUAL COMPLETELY AND FULLY UNDERSTAND IT. FAILURE TO READ AND FOLLOW THESE INSTRUCTIONS COULD RESULT IN INJURY AND/OR DEATH TO THE SHOOTER OR BYSTANDERS AND DAMAGE TO PROPERTY. IF YOU ARE UNABLE TO UNDERSTAND ANY OR ALL OF THIS MANUAL, CALL THE CUSTOMER SERVICE DEPARTMENT AT TRADITIONS®.

In order to shoot your Traditions® ShedHorn™, you will need the following accessories or equipment:

1. Proper eye protection specified for use with firearms.
2. Proper ear protection specified for use with firearms.
3. Black powder or an approved black powder substitute in the appropriate type for your firearm.
4. A powder measure.
5. A powder flask.
6. Projectiles appropriate for your firearm such as Traditions® Smackdown® bullets. ** WARNING: DO NOT USE PROJECTILES NOT RECOMMENDED BY TRADITIONS®.**
7. .50 Caliber Dry Cleaning Patches.
8. Loading/Cleaning Jag appropriate for projectile being used.
9. Bullet Starter.
10. Nipple Pick.
11. Nipple Wrench.
12. Breech Brush Set.
13. An appropriate bore cleaning solvent for muzzleloaders (like EZ Clean2®) or pre-saturated cleaning patches.
14. Musket Caps.
15. Spare Nipple.

Note: While not required, a Traditions® range rod will make loading and cleaning easier and is recommended.

CAUTION: Be sure to read any this manual and any addendums which have been included with this manual and understand what ignition system your muzzleloader has. If you are unsure what type of ignition system is on your muzzleloader, please contact Traditions® customer service department.

10. PREPARING TO CHARGE YOUR SHEDHORN™

 DANGER: ALWAYS POINT THE MUZZLE IN A SAFE DIRECTION AND DO NOT HAVE ANY PART OF YOUR BODY OVER THE MUZZLE WHEN LOADING.

 DANGER: BEFORE YOU BEGIN LOADING, MAKE SURE YOUR SHEDHORN™ IS UNCHARGED AND UNPRIMED.

Prior to loading, we suggest testing and clearing the ignition channel. Please follow these steps:

 DANGER: CONFIRM THAT THE SHEDHORN™ IS UNCHARGED AND THERE ARE NO OBSTRUCTIONS IN THE BARREL.

Point the firearm down towards a safe area on the ground and load a musket cap onto the nipple. Fire one or two caps to blow out any oil or residue from the fire channel. Point the muzzle at a leaf or blade of grass to see if it moves. If it moves, you have a clear channel. If not, fire additional primers or check the breech plug for obstructions.

Another way to see if you have a clear fire channel is to screw a loading/cleaning jag on your ramrod and place a dry patch on the muzzle of your firearm. Push the patch down to the breech plug face and leave ramrod & patch in bore. Point the firearm in a safe direction, place a cap on the nipple and fire. Fire one or two caps then remove the ramrod from the muzzle and inspect patch. The patch should have a complete circular burn in middle. This tells you that you have a clear fire channel. Stand the butt of the firearm on the ground so that the muzzle is pointed up and away from you and others. Never work with your face or any part of your body over the muzzle, even when the muzzleloader is unloaded. Be sure that the firearm is unprimed and unloaded. Your firearm is now ready to be loaded.

11. CHARGING THE SHEDHORN™

⚠ DANGER: ALWAYS POINT THE MUZZLE IN A SAFE DIRECTION AND DO NOT HAVE ANY PART OF YOUR BODY OVER THE MUZZLE WHEN LOADING.

⚠ DANGER: BEFORE YOU BEGIN LOADING, MAKE SURE YOUR SHEDHORN™ IS UNCHARGED AND UNPRIMED.

TO BEGIN LOADING:

1. Place the hammer in the half cock position.
2. Before loading, be sure the nipple is secure. Tighten if necessary. Take care not to overtighten. Always lubricate the threads when installing a nipple.

LOADING THE POWDER IN THE BARREL:

Use only black powder or an approved black powder substitute. Follow the powder manufacturer's instructions when measuring any type of powder. (See p. 51 for more information on black powder and black powder substitutes)

Note: Pelletized powder is not recommended for use in the ShedHorn™.

⚠ WARNING: POWDER CHARGES MEASURED IN VOLUMETRIC UNITS, NOT BY WEIGHT.

When loading loose powder:

1. Fill your Traditions® flask with Black Powder or Black Powder substitute of your choice.



2. Adjust your Traditions® powder measure to the desired correct charge for the type of powder you are using based on the powder manufacturer's recommendations.



3. Pour powder from your Traditions® flask into the powder measure. Pour powder from the powder measure down the barrel.

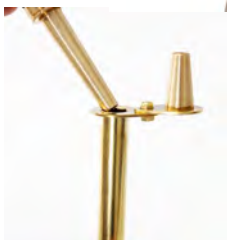

⚠ DANGER: NEVER LOAD POWDER INTO YOUR MUZZLELOADER DIRECTLY FROM A CAN, POWDER HORN, OR FLASK. ALWAYS USE A SEPARATE CALIBRATED POWDER MEASURING DEVICE. A REMAINING SPARK OR EMBER IN THE BARREL MAY CAUSE SERIOUS INJURY AND/OR DEATH TO YOU OR BYSTANDERS AND DAMAGE TO PROPERTY.

4. Tap the side of the barrel to help settle the powder into the breech area.

⚠ WARNING: ALWAYS FOLLOW THE RECOMMENDED LOAD INFORMATION PROVIDED BY THE POWDER MANUFACTURER. FAILURE TO DO SO COULD CAUSE INJURY AND/OR DEATH TO THE SHOOTER AND BYSTANDERS AND DAMAGE TO PROPERTY.

NOTICE: As technology advances and innovation continues, new powders, projectiles, and caps may become available. This manual does not cover every powder, cap, or bullet that is on the market. For the most up to date information, visit www.traditionsfirearms.com, contact our customer service department, or check with the manufacturer if you have questions regarding a new powder, cap, or projectile.

LOADING THE PROJECTILE:

⚠️ WARNING: DO NOT LOAD OR FIRE ANY PROJECTILES THAT ARE NOT APPROVED BY TRADITIONS® FIREARMS DUE TO EXCESSIVE PRESSURES. INJURY AND/OR DEATH TO THE SHOOTER OR BYSTANDERS AND DAMAGE TO PROPERTY MAY OCCUR. VISIT WWW.TRADITIONSFIREARMS.COM.

⚠️ WARNING: SOME STATES MAY REQUIRE USE OF A LEAD ONLY PROJECTILE. WHILE A SABOTED PROJECTILE WILL SHOOT MOST ACCURATELY, A CONICAL BULLET WITH A WEIGHT OF 370 GRAINS OR LESS CAN BE USED WITH LOOSE BLACK POWDER OR LOOSE PYRODEX.

⚠️ DANGER: USE ONLY HIGH QUALITY FACTORY-MADE PROJECTILES WHICH MATCH THE CALIBER DESIGNATION ON YOUR FIREARM BARREL.

⚠️ WARNING: BE SURE ONLY ONE PROJECTILE IS CHARGED IN THE BARREL. DO NOT LOAD A PROJECTILE ON TOP OF ANOTHER. INJURY AND/OR DEATH TO THE SHOOTER OR BYSTANDERS AND DAMAGE TO PROPERTY MAY OCCUR.

TRADITIONS® SMACKDOWN® SABOTED BULLETS:

The plastic material used in Traditions® sabots is self-lubricating. Do not pre-lube your Smackdown® Bullet or sabots. NOTE: Always follow the projectile manufacturer's loading instructions.

1. Insert the base of the projectile into the sabot, making certain the projectile is firmly and fully seated against the bottom of the sabot.
2. Place the assembled projectile into the muzzle.
3. Start the projectile with your thumb.
4. Using a bullet starter, place the shaft on top of the projectile and push it downward until the starter hits the top of the muzzle.



5. With the concave end of the loading jag on your ramrod, position the ramrod on top of the projectile inside the bore. Holding the ramrod no further than 6" over the bore, apply firm pressure downward until the projectile is seated against the powder charge. (Holding the ramrod higher will increase your chances of breaking your ramrod.)
6. To avoid the dangers of loading more than one projectile, the first time you load your ShedHorn™ you must insert the ramrod and mark the bullet seated location on the ramrod.

⚠ WARNING: WE RECOMMEND THAT ANY TIME YOU CHANGE TO A DIFFERENT PROJECTILE IN THE SHEDHORN™ THAT YOU FOLLOW THIS PROCEDURE. WE RECOMMEND THE USE OF A NEW RAMROD WITH A MARK SOLELY FOR THAT SPECIFIC PROJECTILE.

7. Make sure to remove the ramrod from the barrel before firing the ShedHorn™.



⚠ DANGER: NEVER PLACE YOUR HAND OVER THE RAMROD AFTER INTRODUCTION OF THE PROJECTILE INTO THE BARREL. WHILE UNLIKELY, A DISCHARGE ON LOADING COULD EXPEL THE RAMROD AND CAUSE INJURY AND/OR DEATH.

IMPORTANT: ALWAYS SEAT THE PROJECTILE FIRMLY ON TOP OF THE POWDER CHARGE. FAILURE TO DO SO MAY RESULT IN INJURY AND/OR DEATH TO THE SHOOTER OR BYSTANDERS AND DAMAGE TO PROPERTY.

MARKING THE RAMROD TO SHOW WHEN THE SHEDHORN™ HAS A PROPERLY SEATED PROJECTILE WILL ALLOW THE USER TO KNOW IF THE SHEDHORN™ HAS BEEN DOUBLE CHARGED OR IF THE PROJECTILE IS NOT SEATED ALL THE WAY AGAINST THE POWDER CHARGE.

12. PRIMING THE SHEDHORN™

⚠ DANGER: ALWAYS POINT THE MUZZLE IN A SAFE DIRECTION AND DO NOT HAVE ANY PART OF YOUR BODY OVER THE MUZZLE WHEN LOADING.

⚠ WARNING: DO NOT PRIME YOUR SHEDHORN™ UNTIL YOU ARE PREPARED TO FIRE.

⚠ WARNING: WEAR PROPER EYE PROTECTION WHEN LOADING.

When priming your ShedHorn™ follow these instructions. Only prime your muzzleloader after you have charged the firearm and you are ready to shoot. When in the field, you should carry your firearm with the hammer in the half cock position.

1. Place the recommended musket cap on the nipple.



13. FIRING THE TRADITIONS®

SHEDHORN™

 **DANGER: ALWAYS POINT THE MUZZLE IN A SAFE DIRECTION AND BE SURE OF YOUR TARGET AND WHAT IS BEYOND IT.**

 **WARNING: BE SURE TO WEAR PROPER EYE AND EAR PROTECTION ANY TIME YOU FIRE YOUR SHEDHORN™. MAKE SURE ALL BYSTANDERS IN THE AREA ARE ALSO WEARING PROPER EYE AND EAR PROTECTION AT ALL TIMES.**

 **WARNING: ALWAYS MAINTAIN PROPER FIREARM HANDLING PROCEDURES DESCRIBED IN THIS MANUAL.**

 **WARNING: NEVER FIRE THE SHEDHORN™ WITH ONLY LOOSE POWDER AND NO PROJECTILE. THIS COULD RESULT IN PARTICLES EXITING THE BARREL.**

Now after following the previous loading instructions, your ShedHorn™ is charged, primed, and ready to fire.

1. Grasp the ShedHorn™ firmly with both hands with your finger off the trigger and out of the trigger guard. Raise the ShedHorn™ up and firmly pull the stock into your shoulder.
2. Pull the hammer back slowly until it is in the full cock position. The ShedHorn™ is now cocked and ready to fire. **Never carry the ShedHorn™ in the full cock position. If you decide not to fire, see page 36.**

 **WARNING: DO NOT PULL THE HAMMER INTO THE FULL COCK POSITION UNTIL YOU ARE READY TO FIRE.**

3. If using the set trigger, slowly pull the set trigger (the rear trigger) rearward until you feel it lock into place. This increases the sensitivity of the front trigger. You do not need to use the set trigger to fire.
4. Acquire your target and aim with your sights or scope. Remember to be sure of what is beyond your target.
5. Slowly squeeze the front trigger until the ShedHorn™ fires.

 **WARNING: THE TRIGGERS ON THE SHEDHORN™ ARE SET AT THE FACTORY AND ARE NOT ADJUSTABLE.**

CAUTION: WAIT AT LEAST ONE MINUTE BEFORE RELOADING TO ENSURE THAT NO SPARK OR SMOLDERING EMBERS REMAIN IN THE BARREL THAT COULD IGNITE NEW/FRESH POWDER.

14. DEPRIMING YOUR SHEDHORN™ AFTER FIRING:

1. With the firearm pointed in a safe direction, pull the hammer rearward into the half cock position.
2. Remove the musket cap from the nipple and discard.



15. DECOCKING YOUR SHEDHORN™ IF YOU DECIDE NOT TO FIRE

⚠ WARNING: ALWAYS KEEP THE MUZZLE POINTED IN A SAFE DIRECTION AND BE SURE OF YOUR TARGET AND WHAT IS BEYOND IT.

If your ShedHorn™ is in the full cock position and you no longer want to fire the ShedHorn™, carefully follow these steps to decock the firearm.

1. Both hands should be dry and not impeded in any way.
2. Remove the musket cap from the nipple.
3. With the hammer remaining in the full cock position, carefully pull the hammer further rearward.
4. Carefully, while holding your thumb on the hammer in the cocked position, depress the front trigger slowly until you feel the hammer release. Immediately release your finger from the trigger and slowly lower the hammer in a controlled manner into the half cock position. You will feel the hammer lock and then pull back slowly into the half cock position.

NOTE: Practice this with an unloaded firearm so you feel comfortable with the process of safely lowering the hammer.

⚠ WARNING: NEVER DRY FIRE YOUR FIREARM.

16. MISFIRES & HANGFIRES

If, after following the previous loading and firing instructions, the ShedHorn™ did not fire then you have had a Misfire or Hangfire. Anyone involved with firearms may experience a misfire or hangfire at one time or another. The following are a few simple procedures that will help you to effectively manage such occurrences.

 WARNING: A MISFIRE OR HANGFIRE IS A DANGEROUS SITUATION AND IT IS IMPERATIVE YOU PROCEED WITH EXTREME CAUTION. AS YOU ALWAYS SHOULD DO, BUT ESPECIALLY IN THIS SITUATION, BE SURE TO KEEP THE SHEDHORN™ POINTED IN A SAFE DIRECTION AS IT MAY FIRE AT ANY TIME.

MISFIRE

A **MISFIRE** is a failure of either the cap powder or the main charge to ignite. This could be a very hazardous situation.

 WARNING: Extreme caution should be exercised when dealing with a misfire or hangfire.

Rarely is a misfire the fault of the firearm. Generally, it can be attributed to a problem with the propellant or cap or improperly cleaning the firearm. Should your ShedHorn™ fail to fire for any reason, **keep the ShedHorn™ pointed at your down-range target for at least one minute. By doing so, you make sure you are prepared for the chance of a delayed ignition.**

1. Keep the barrel pointed upward and toward your target. Wait at least one minute. By doing so, you will make sure you are prepared for the chance of a delayed ignition, also called “hangfire”.
2. After this interval, with the firearm pointed in a safe direction, set the hammer at half-cock and remove the musket cap from the nipple. Discard this cap.
3. Insert a nipple pick or fine wire deeply into the hole of the nipple to ensure that the hole is not clogged. With the palm of your hand, slap the barrel on the lock side to force powder into the nipple area.
4. Place a new musket cap on the nipple. Set the hammer to full cock. With the firearm pointed in a safe direction, attempt to fire again.
5. If ignition still does not result, keep the firearm pointed in a safe direction for one minute.

6. With the firearm pointed in a safe direction, pull the hammer rearward into the half cock position and remove the musket cap from the nipple. Discard this cap.
7. Remove the nipple with your nipple wrench.
8. Introduce a small amount of black powder into the nipple hole by slapping the left side of the firearm with the palm of your hand. This will attempt to induce powder as far into the barrel as possible.
9. Re-install the nipple.
10. With the firearm pointed in a safe direction, place the hammer in the half cock position and install a new percussion cap. Attempt to fire the firearm again.

If the above techniques do not work, there may be a charge or an obstruction that must be removed from the barrel.

To see if the firearm is charged or if there is an obstruction, place the hammer in the half cock position and remove the musket cap from the nipple. Keep the muzzle pointed in a safe direction and insert the ramrod provided with the firearm into the bore. You should use the marks you made on the ramrod for charged and uncharged to determine if there is powder and projectile in the barrel. For more information on checking if your firearm is unloaded, see page 24. If there is powder, a projectile, or a full charge in the barrel, remove the charge by disassembling the firearm following the disassembly instructions on page 44.

If you are unable to remove the charge, contact a local gunsmith or Traditions® Customer Service Department for assistance.

 WARNING: It is in violation of Federal Law to ship a charged firearm. If your firearm has a live charge and/or projectile in the barrel, please take it to a local gunsmith for removal or call Traditions® Customer Service Department at 860-388-4656.

HANGFIRE

A hangfire is a delayed ignition. The cap fires when the trigger is pulled and the main charge fires a brief moment later. There are many reasons that hangfires occur. If you are experiencing hangfires, there are possible causes that you need to evaluate. Verify the following:

1. Verify that the cap is the correct size and properly fitted onto the nipple.
2. Inspect that the ignition channel is clear of obstructions.
3. Verify that the proper propellant is being used and that it is the proper granulation and is free from moisture, contamination and oils.
4. Check the condition of the cap and propellant powder. For hunting situations, it is a wise practice to use fresh caps and powder. Use a fresh load for each day's hunting. We recommend unloading the powder charge and projectile after each hunting or shooting session to avoid the possibility of double loading your ShedHorn™ rifle.

If you experience a **HANGFIRE** keep the ShedHorn™ pointed down range for one minute. The ShedHorn™ could fire so be prepared for this. If the firearm does not fire after one minute, keep the ShedHorn™ pointed downrange, place the hammer in the half cock position, and remove the cap. Carefully unload your firearm following the unloading instructions on page 40. Dispose of defective primers and powder in accordance with your local, state, and federal laws and regulations.

17. UNLOADING THE SHEDHORN™

 **DANGER: ALWAYS POINT THE MUZZLE IN A SAFE DIRECTION AND DO NOT HAVE ANY PART OF YOUR BODY OVER THE MUZZLE WHEN UNLOADING.**

There are two different methods for removing the projectile and charge:

Note: It is recommended to use either a Traditions® range rod or ramrod extension for this method.

Method 1 - Removing the Breech Plug

1. Make sure the muzzle of the barrel is pointed in a safe direction at all times.
2. Place the hammer in the half cock position and remove the cap from the nipple.
3. Follow the disassembly instructions on page 44 to remove the barrel from the firearm.
4. Grasp the barrel in one hand and use the other hand to rotate the breech plug counter clockwise to remove from the barrel.

If the breech plug is difficult to remove:

- A. Place the barrel in a padded vice to allow for better leverage and use a 6mm Allen wrench to remove the breech plug. Insert the post of the wrench into the hex socket in the back of the breech plug and turn the handle counter clockwise. OR
 - B. Spray penetrating oil down the muzzle of the barrel and let sit for one hour.
5. Remove the powder from the breech. Gently tap the barrel to remove loose powder.
 6. Insert a ramrod or range rod into the breech end of the barrel and push the projectile out the muzzle end of the barrel.
 7. Clean and dry the bore of the barrel making sure the breech area is dry before reassembly your firearm.

Method 2 - Leaving the Breech Plug In Place

1. Make sure the muzzle of the barrel is pointed in a safe direction at all times.
2. Place the hammer in the half cock position and remove the cap from the nipple.

3. Follow the disassembly instructions on page 44 to remove the barrel from the firearm.
6. Using a range/bench ramrod, with a ball puller screw in one end, insert the screw end into the muzzle until the screw makes contact with the projectile. **TIP: It may be easier if you put the firearm in a vise.**
7. Apply pressure to the end of the ramrod while at the same time turning it, allowing the ball puller screw to bite into the projectile.
8. Continue turning the ramrod until you can determine that the ball/bullet puller screw is well anchored into the projectile.
9. Firmly grasp the exposed end of the ramrod with projectile attached, pull it through the barrel and out of the muzzle. One continuous non-stop pull is generally best.

Note: When extracting sabot bullets the first few inches of the pull will separate the projectile from the plastic sabot. At this point the bullet will be free from the sabot and will come out easily. It will then be necessary to reinsert the ball puller screw back down the barrel and screw it into the plastic sabot and also pull it out.



CAUTION: DISCARD ANY BULLET REMOVED FROM THE BARREL. THE BULLET MAY HAVE BECOME DEFORMED OR THE SABOT MAY BECOME COMPROMISED WHEN UNLOADING.

10. Remove all powder by lightly tapping the end of the barrel.
11. Clean and dry the bore of the barrel making sure the breech area is dry before reassembling your firearm.

18. CLEANING & MAINTENANCE

 WARNING: ALWAYS POINT THE SHEDHORN™ IN A SAFE DIRECTION AND TREAT THE FIREARM AS IF IT WAS LOADED AND CAN FIRE.

 WARNING: CONFIRM THE SHEDHORN™ IS UNLOADED, UNPRIMED, AND IN THE HALF COCK POSITION BEFORE CONDUCTING ANY OF THE METHODS IN THIS SECTION.

 WARNING: DO NOT DISASSEMBLE YOUR SHEDHORN™ ANY FURTHER THAN WHAT IS DESCRIBED IN THIS MANUAL.

Disassembling your ShedHorn™ further could cause the firearm to become unsafe. As a result, it could cause serious injury and/or death to the shooter or bystanders and could damage the ShedHorn™.

 WARNING: CONFIRM NO POWDER CHARGES, CAPS, OR PROJECTILES ARE PRESENT OR AVAILABLE DURING ANY DISASSEMBLY, CLEANING, OR REASSEMBLY.

NOTE: Reference to the exploded view diagram in the manual will help identify part names and numbers.

RANGE/FIELD CLEANING AND ADVICE **WHILE SHOOTING**

A systematic routine of cleaning while shooting is strongly advised to aid in avoiding problems while loading and to optimize accuracy. When target shooting or sighting in, develop a habit of consistently cleaning your barrel after each shot. Depending upon the specific load, temperature, and humidity, a short series of shots with black powder or black powder substitute can be fired before it becomes necessary to clean your barrel and remove fouling build-up.

Suggested Method

Make sure the ShedHorn™ is uncharged and unprimed. The hammer should be in the half cock position and should always be pointed in a safe direction. Be sure there is no cap on the nipple. After one to two shots, or when you feel resistance in loading the projectile, take your ramrod or range rod and attach a loading/cleaning jag. Place a saturated cleaning patch (such as an EZClean2® Pre-Saturated Cleaning Patch) over the end of your rod and insert it into the muzzle end of the ShedHorn™. Using short strokes, run the patch up and down to remove any fouling. Remove the saturated patch and discard. Place a dry patch over the end of the rod and run the dry patch from the muzzle to the breech to remove any moisture. Do this until the patch is clean. Repeat this process as many times as necessary until your barrel is clean.

 DANGER: NEVER REMOVE THE BOLSTER DRUM FROM THE BREECH PLUG. REMOVAL OR ALTERATION WILL COMPROMISE PERFORMANCE OF THE FIREARM, CREATE AN UNSAFE SITUATION, AND VOID YOUR WARRANTY.

ADDITIONAL RANGE CLEANING ADVICE

NOTE: Shooting Patches are not recommended for cleaning as they are too small for this process and can be lost in the bore. If a patch becomes lost in the bore, use a Traditions® Patch Puller Worm attached to a ramrod for retrieval. **Never load a charge over a lost patch.**

1. If unusual resistance is felt while loading a projectile, place an EZ Clean2® cleaning patch on a cleaning jag affixed to the end of a ramrod and run it the full length of the barrel several times with your objective being to remove as much of the fouling build up as possible.
2. If for any reason the projectile will not go all the way down to the powder charge, it will be necessary to extract the projectile from the barrel either with a bullet puller on a ramrod or the breech plug can be removed, the charge removed and the projectile forced out the end of the barrel with a long bench/range rod or an extended ramrod.

NOTE: It should never be necessary to hammer or excessively force a projectile down the bore. Projectiles should load firmly against the powder charge with a series of short strokes. If the projectile is the proper size, unusual resistance usually indicates the need to swab the bore with a treated cleaning patch. Use EZClean2® solvent if barrel is heavily fouled. An occasional cleaning of the bore with a brass Traditions® Bore Brush is advisable to remove excessive plastic and fouling build-up.

NOTE: A dirty fouled barrel will directly affect your ability to group shots. However, in a hunting situation, only a few shots will likely be taken. If the barrel is prepped at the onset, it is not necessary to clean the interior of the barrel between shots when hunting.

19. DISASSEMBLY, DETAILED CLEANING, & REASSEMBLY

 WARNING: ALWAYS POINT THE SHEDHORN™ IN A SAFE DIRECTION AND TREAT THE SHEDHORN™ AS IF IT WAS LOADED AND CAN FIRE.

 WARNING: CONFIRM THE SHEDHORN™ IS UNCHARGED AND UNPRIMED BEFORE CONDUCTING ANY OF THE METHODS IN THIS SECTION.

 DANGER: DO NOT DISASSEMBLE YOUR SHEDHORN™ ANY FURTHER THAN WHAT IS DESCRIBED IN THIS MANUAL.

Disassembling your ShedHorn™ further could cause the firearm to become unsafe. As a result, it could cause serious injury and/or death to the shooter or bystanders and could damage the ShedHorn™.

 DANGER: NEVER REMOVE THE BOLSTER DRUM FROM THE BREECH PLUG. REMOVAL OR ALTERATION WILL COMPROMISE PERFORMANCE OF THE FIREARM, CREATE AN UNSAFE SITUATION, AND VOID YOUR WARRANTY.

Required Tools & Supplies

- Dry Patches
- 6mm Allen Wrench
- Traditions® Range Rod or Ramrod with Jag
- Pipe Cleaners
- Safety Glasses
- Cleaning Jag
- Bore Solvent or Pre-Saturated Cleaning Patches
- Nipple Wrench
- Breech Plug Grease
- Bronze Bore Brush
- Seasoning Patches
- Nipple Pick
- Breech Plug Wrench
- Screw driver
- Rubber Mallet
- Non-marring Punch or wedge puller

The disassembly procedure is most often used for general cleaning, lubrication, and inspection of your Traditions® ShedHorn™. Traditions® recommends this be completed after each shooting session. By following this procedure it will help keep your ShedHorn™ shooting safely and reliably for years to come.

DISASSEMBLY

 WARNING: CONFIRM THE SHEDHORN™ IS UNLOADED, UNPRIMED, AND IN THE HALF COCK POSITION BEFORE CONDUCTING ANY OF THE METHODS IN THIS SECTION.

1. Check if the muzzleloader is unloaded, follow the steps on page 24. Once the muzzleloader is unloaded, you can proceed with disassembly.

2. Remove the ramrod from the thimbles.

3. Carefully remove the barrel wedge from the lock side of the firearm by using a wedge puller or a non-marring punch and rubber mallet.



4. Remove both lock plate screws with a flat head screwdriver. The ramrod retaining spring will be detached from the screw and will require re-installation upon reassembly.



5. Remove the tang screw with a flat head screwdriver. Set aside.



6. Lift the barrel up slightly and then pull it straight out of the stock. You may need to twist the barrel slightly to pull the barrel away from the tang. If the tang screw is not removed or if there is too much upward pressure when lifting the barrel, this can bend or break the tang.

⚠ WARNING: IMPROPER REMOVAL OF THE BARREL WILL DAMAGE THE TANG AND IS NOT COVERED UNDER WARRANTY.



7. Grasp the barrel in one hand and use the other hand to rotate the breech plug counter clockwise to remove from the barrel.

If the breech plug is difficult to remove:

- A. Place the barrel in a padded vice to allow for better leverage and use a 6mm Allen wrench to remove the breech plug. Insert the post of the wrench into the hex socket in the back of the breech plug and turn the handle counter clockwise. OR



- B. Spray penetrating oil down the muzzle of the barrel and let sit for one hour.

⚠ DANGER: NEVER REMOVE THE BOLSTER DRUM FROM THE BREECH PLUG. REMOVAL OR ALTERATION WILL COMPROMISE PERFORMANCE OF THE FIREARM, CREATE AN UNSAFE SITUATION, AND VOID YOUR WARRANTY.

8. From the breech plug, remove the nipple with your nipple wrench and clean out screw with a screw driver. Set aside.

Your firearm is now disassembled.

DETAILED CLEANING

⚠ WARNING: WEAR SAFETY GLASSES WHILE CLEANING TO PROTECT EYES FROM FLYING SPRINGS OR SOLVENTS.

Detailed cleaning, lubrication, and inspection of the entire ShedHorn™ system should be performed after you are done shooting for the day and before storing for an extended period of time. Performing this detailed cleaning will help keep your ShedHorn™ in its' best operating condition.

After following the disassembly instructions, your ShedHorn™ should be disassembled.

Follow all safety rules listed previously in this manual.

1. Using Traditions® Range Rod or your ramrod, attach a Bronze Brush to your ramrod. **Note: We recommend the Bronze Brush because it is excellent at hard scrubbing and removing fouling.**
2. Spray a bore solvent, such as Traditions® EZClean2®, on your bronze brush. Note: Traditions® Foaming Bore Solvent can also be used instead of spraying the bore solvent on the bronze brush. Allow solvent to sit for 15 minutes inside the barrel. This will allow time for the solvent to engage and penetrate the fouling. Do not let it dry.

3. To clean your breech plug, spray the breech plug inside and out with solvent or drop the breech plug into the EZClean2® parts bath system to loosen the residue and fouling on the plug. Let the solvent sit or if using the parts bath method, let the breech plug sit in the solvent for 10 minutes. Use a stiff brush to clean the outside threads and inner area of the breech plug including the fire channel. A pipe cleaner can be used to get the smaller areas clean and dry. Wipe with a clean cotton cloth. Repeat until all residues are off.
4. To clean your nipple, you can drop into the same parts bath as the breech plug or spray the outside and inside with solvent. Using the nipple pick, remove any fouling. Wipe with a clean cotton cloth. Repeat until all residues are off.
5. Clean inside the bolster where the clean out screw was removed from. Spray solvent into the bolster area and clean this area with a pipe cleaner. Wipe with a clean cotton cloth. Repeat until all residues are off.

6. To clean your barrel, insert your bronze brush into the breech area. Push the ramrod from the breech to the muzzle until the brush exits the muzzle. Pull the ramrod back through the barrel towards the breech. The technique allows you to help break up fouling.



7. Remove the bronze brush from the ramrod and attach the cleaning jag.

8. Place a dry cotton patch over the jag and insert it into the breech. Run the ramrod with the patch from the muzzle to the breech. Pull the ramrod back through to the muzzle. Repeat until patch comes out clean.



9. Using a Traditions® Cleaning & Seasoning Patch or some gun lube on a dry patch, place the patch over the cleaning jag and insert into the muzzle. Push the patch from the muzzle to the breech. This will help protect against rust and allow for easier loading.



10. Apply a light coating of gun oil to the outside of the barrel and all metal surfaces.



11. Lubricate the threads of the nipple with grease.

12. Generously lubricate the threads of the breech plug with breech plug grease. Not using the recommended lubricant will cause o-ring damage and breech plug seizure.



You have completed the detailed cleaning of your ShedHorn™. You can now reassemble your firearm.

REASSEMBLY

1. Reinstall the Clean Out Screw into the bolster with a screw driver. **DO NOT OVERTIGHTEN.**
2. Reinstall nipple into the breech plug. **DO NOT OVERTIGHTEN AND DO NOT CROSS THREAD.**
3. Reinstall the Accelerator™ Breech Plug.

Note: Before attempting to install the Accelerator Breech Plug™ be sure to inspect the fire channel of the breech plug to make sure it is clean and free of any obstructions.

Place the lubricated breech plug in the barrel and thread the breech plug into the barrel using your fingers and rotating the breech plug in a clockwise rotation. Continue to do so until the Accelerator Breech Plug™ makes contact with the barrel and seats firmly.

Be sure to follow the timing mark on the barrel to install the breech plug properly.



CAUTION: If the breech plug does not thread smoothly or seat fully, remove it and visually inspect the o-ring for wear and the threads on the plug and inside the barrel for fouling or obstructions. With proper maintenance and care the o-ring will last many years. The o-ring is in place as a gas check and helps to block fouling from reaching the threads. The plug can still be used without the o-ring but may become difficult to remove due to the fouling that will take place.

4. Install the lock plate screws loosely. Do not fully tighten at this time.

5. To re-install the ramrod retaining spring, place the forward lock plate screw through the loop on the ramrod retaining spring. Let the free curled end of the spring face back towards the buttstock with the curved side (belly side) of the spring facing downward. The curved side (belly side) of the spring rests against the ramrod putting tension on it to help keep it from rattling out of place.



6. Install the tang loosely by setting it into place within the stock. Do not tighten the tang screw.



7. Set the breech plug end of the barrel into the tang and lower the barrel into the stock channel. Be sure the barrel is fully seated in the stock. You may need to wiggle it a bit for it to drop into the channel. You should be able to see clearly through the wedge.



⚠ WARNING: IMPROPER INSTALLATION OF THE BARREL WILL DAMAGE THE TANG AND IS NOT COVERED UNDER WARRANTY.

8. With the barrel in place, tighten the tang screw.



9. Tighten both the front and rear lock plate screws into place. **Do not overtighten.**

10. Carefully re-install the barrel wedge from the lock plate side of the firearm by using a wedge puller or a non-marring punch. Be sure the tenon inside is aligned with the wedge plate. You should be able to see through the tenon. If it doesn't go in easily, do not force it.



11. Install the ramrod through the thimbles.



Reassembly of the ShedHorn™ is now complete.

⚠ WARNING: DO NOT FIRE YOUR SHEDHORN™ WITH EXCESS GREASE, OIL, OR OTHER MATERIAL IN THE BORE. These lubricants or solvents can partially or fully obstruct the bore which could result in damage to the firearm or injury to the shooter and/or bystanders.

⚠ WARNING: Store your ShedHorn™ uncharged and unprimed in a cool, dry, secured area. Storage in a gun case should be avoided as it may hasten condensation and corrosion. During long periods of storage, periodically check for signs of pitting or rusting on the surface and in the barrel.

⚠ WARNING: FIREARM SECURITY IS YOUR PERSONAL RESPONSIBILITY. ALWAYS SAFELY STORE AND SECURE YOUR FIREARM. You must ensure that your firearms are securely and safely stored so that children and/or unauthorized users may not obtain them. Your firearms should always be kept unloaded and locked when not in use or in your immediate control. Never assume that the use of a lock alone is sufficient to safely secure your firearm. You must continually evaluate your personal situation and employ security systems that prevent children and unauthorized users from gaining access to your firearm. It is recommended that you secure bullets, loading components, and primers in a locked container separate from your firearms.

ADDITIONAL INFORMATION ON BREECH PLUGS

Tips for Stuck Breech Plugs:

Important: Always make sure to lubricate the breech plug threads liberally with Traditions® breech plug grease before using your muzzleloader to help avoid having a stuck breech plug.

1. With the breech plug wrench fitted over the breech plug, actually try to tighten the plug and then rock it back and forth to loosen up the fouling.
2. Remove the barrel from the frame. Put it in a bucket and pour some hot water into the barrel and let it soak for about a 1/2 hour. Secure the barrel in a padded vise. Position the wrench onto the breech plug and remove. Be careful not to scald yourself with the hot water.
3. If you still cannot remove your breech plug contact the Traditions® Customer Service Department.

20. INFORMATION ON BLACK POWDER & BLACK POWDER SUBSTITUTES.

⚠ WARNING: ALWAYS FOLLOW THE RECOMMENDED LOAD INFORMATION PROVIDED IN THIS BOOK OR BY THE POWDER OR BULLET MANUFACTURER. FAILURE TO DO SO COULD CAUSE INJURY AND/OR DEATH TO THE SHOOTER AND BYSTANDERS AND DAMAGE TO PROPERTY.

As a muzzleloading firearm shooter you become a reloader in addition to being the shooter. This adds another aspect of responsibility to you and requires that you strictly adhere to the proper safe charging of your firearm regardless of what type of black powder or black powder substitute you use. Failure to properly follow these instructions and the powder manufacturer's recommendations may cause damage to the firearm and injury and/or death to the shooter or bystanders and damage to property.

NOTICE: As technology advances and innovation continues, new powders, projectiles, and caps may become available. This manual does not cover every powder, cap, or bullet that is on the market. For the most up to date information, visit www.traditionsfirearms.com, contact our customer service department, or check with the manufacturer if you have questions regarding a new powder, cap, or projectile.

⚠ DANGER: NEVER USE MORE THAN 150 GRAINS (OR THE EQUIVALENT) OF BLACK POWDER OF ANY TYPE FROM ANY MANUFACTURER.

BLACK POWDER

Black powder gunpowder is the original propellant of firearms and is still quite useful to this day. Black powder is generally available in four different granule sizes which determines the appropriate use for the powder. The burn rate of black powder depends on its grain size. Larger granules burn at a slower rate and therefore work best in large diameter rifles or cannons; while smaller granules burn at a faster rate and work best in small caliber rifles or pistols. Selecting the correct granulation is imperative for the best reliable performance of your muzzleloading firearm.

Note: When purchasing black powder make sure that the granulation or type is clearly marked on the manufacturer's container so you can assure you are purchasing the correct powder for your application.

FG (also referred to as 1Fg or Single “F”)

This is a very coarse black powder best suited to very large bore rifles and shotguns (10, 8, 4 gauge) that were produced in the past. This powder is one that you will not find very much use for and as such is not often seen for sale.

FFG (also referred to as 2Fg or Double “F”)

This is a popular granulation as it has a wide variety of applications. Suitable for rifles .50 caliber and over, black powder shotguns in 12, 16, and 20 gauge and sometimes in large caliber single shot pistols (larger than .50 caliber).

FFFG (also referred to as 3Fg or Triple “F”)

Since it is used in a wide variety of applications this is the most popular and available granulation of black powder. Suitable for use in rifles and single shot pistols .50 caliber and under, as well as in all percussion (cap & ball) revolvers; this powder is the most versatile black powder available.

FFFFG (also referred to as 4Fg or Four “F”)

This is the smallest grain of the commonly available black powders and with its fast burn rate has limited applications. The best and most common application of this powder is for the priming of the flash pan on a flintlock. Since it has such limited applications it can sometimes be hard to find at retailers.

 **WARNING:** Traditional black powder is extremely flammable therefore proper handling and storage procedures from the manufacturer should be strictly followed. If you have any concerns or questions on how exactly to handle or store black powder contact the manufacturer of the powder. Additional information on black powder storage is available from the National Fire Protection Association, 1 Batterymarch Park, Quincy, MA. 02269. (www.nfpa.org). They can be contacted by calling 1-800-344-3555 or emailing custserv@nfpa.org. Ask for pamphlet #495 for information regarding black powder.

BLACK POWDER SUBSTITUTES

In addition to traditional black powder there are now a multitude of suitable black powder substitutes that are appropriate for use in Traditions® muzzleloading firearms. These powders can offer advantages over traditional black powder but sometimes require specific types of ignition and it is important to consult the powder manufacturer's instructions on appropriate ignition types.

Some black powder substitutes are offered in differing granulations similar to black powder, while others are only offered in one granulation. It is important that you select the appropriate powder and granulation for your specific application and firearm.

In addition most black powder substitutes relate closely to black powder on a volume to volume basis but not by weight. For this reason black powder substitutes are measured by volume as opposed to by weight. When using a black powder measure you must follow the powder manufacturer's instructions on adjusting the measuring of the powder charge compared to what charge you would normally use with black powder.

⚠ WARNING: DO NOT USE PYRODEX® CTG. While Pyrodex CTG is a black powder substitute, it is designed to be used in cartridge firearms which use cartridges that originally used black powder as their charge. It is not safe or recommended for use in muzzleloading firearms.

TYPES OF BLACK POWDER & BLACK POWDER SUBSTITUTES

Traditions® does not sell or endorse any specific brand of black powder or black powder substitute. However listed below are some of the currently available black powder or black powder substitutes that are approved for use in Traditions® ShedHorn™. Please refer to the powder manufacturer for the proper loading and measuring techniques as they can vary from manufacturer to manufacturer. If there is ever a question on the appropriate application of a certain powder or the safety of a specific powder charge you must contact the manufacturer of the powder as the source for this information.

Follow the safe handling and storage precautions printed on the manufacturer's container and never purchase or use any powder that has been removed from their manufacturer's original container.

⚠ DANGER: NEVER UNDER ANY CIRCUMSTANCE USE SMOKELESS POWDER OF ANY TYPE OR IN ANY QUANTITY IN A MUZZLELOADING FIREARM, AND NEVER MIX POWDERS. The use of any smokeless powder at all could result in a detonation or explosion which could cause injury and/or death to the shooter or bystanders and damage to property.

⚠ WARNING: NEVER EXCEED THE RECOMMENDED MAXIMUM BLACK POWDER OR BLACK POWDER SUBSTITUTE CHARGE LISTED IN THIS BOOK OR BY THE POWDER MANUFACTURER. If the recommended maximum charge is exceeded then injury or death to the shooter or bystanders can occur.

⚠ WARNING: FOLLOW THE POWDER MANUFACTURER'S INSTRUCTIONS.

Musket Cap Suggestions

Traditions® does not sell or endorse any specific brand of musket caps for the ShedHorn™. For the most up to date information on suggested primers, please visit www.traditionsfirearms.com, contact our customer service department, or check with the cap manufacturer or powder manufacturer to be sure you are using compatible products.

21. SUGGESTED LOADS FOR THE SHEDHORN™

 **WARNING:** 8 C 'BCH' @C58 'CF': #9'5 BMDFC>97H@G'H<5H'5 F9' BCH'5 DDFCJ98 '6 MHF58 #CBG®: #95 FAG'8I 9'HC'9L79GGJ9' DF9GGI F9G" #B>I FM5 B8#CF'895H<'HC'H<9'G<CCH9F'CF' 6MGH5 B89FG'5 B8'85A5; 9'HC'DFCD9FHMA5MC77I F"J-GH' KKK 'HF58 #CBG: #95 FAG'7CA"

 **WARNING:** NEVER EXCEED THE RECOMMENDED MAXIMUM BLACK POWDER OR BLACK POWDER SUBSTITUTE CHARGE LISTED IN THIS BOOK OR BY THE POWDER MANUFACTURER. If the recommended maximum charge is exceeded then injury or death to the shooter or bystanders can occur.

 **WARNING:** WHILE A SABOTED PROJECTILE WILL SHOOT MOST ACCURATELY, A CONICAL BULLET OF 370 GRAINS OR LESS CAN BE USED WITH LOOSE BLACK POWDER OR LOOSE PYRODEX.

 **DANGER:** USE ONLY HIGH QUALITY FACTORY-MADE PROJECTILES WHICH MATCH THE CALIBER DESIGNATION ON YOUR FIREARM BARREL.

 **WARNING:** BE SURE ONLY ONE PROJECTILE IS LOADED IN THE BARREL. DO NOT LOAD A PROJECTILE ON TOP OF ANOTHER. INJURY AND/OR DEATH TO THE SHOOTER OR BYSTANDERS AND DAMAGE TO PROPERTY MAY OCCUR.

 **WARNING:** FOLLOW THE POWDER MANUFACTURER'S INSTRUCTIONS.

 **WARNING:** NEVER UNDER ANY CIRCUMSTANCE USE SMOKELESS POWDER OF ANY TYPE OR IN ANY QUANTITY IN A MUZZLELOADING FIREARM, AND NEVER MIX POWDERS. The use of any smokeless powder at all could result in a detonation or explosion which could cause injury and/or death to the shooter or bystanders and damage to property.

There are many projectiles in the marketplace which would be appropriate for use in the ShedHorn™. Be sure it is a bullet that is specific for muzzleloaders or has been rated for muzzleloader use. Bullets are ever changing and there may be new bullets on the market that are not on our suggested list. Please visit www.traditionsfirearms.com for full ballistic information or contact our customer service department with any questions regarding which projectiles are best used in your ShedHorn™.

Pelletized powder is not recommended for use in the ShedHorn™.

Recommended Loads for Saboted Projectiles

 **WARNING: POWDER CHARGES MEASURED IN VOLUMETRIC UNITS, NOT BY WEIGHT.**

Bullet Weight	Sabot/Bullet Dia.	Powder	Powder Charge	Velocity FPS
250 gr. Smackdown®	50/45	777 Powder 2F	80 gr. VU Min.	1200
250 gr. Smackdown®	50/45	777 Powder 2F	100 gr. VU Max.	1375
250 gr. Smackdown®	50/45	Pyrodex RS	80 gr. VU Min.	1550
250 gr. Smackdown®	50/45	Pyrodex RS	100 gr. VU Max.	1706
290 gr. Smackdown®	50/45	777 Powder 2F	80 gr. VU Min.	1100
290 gr. Smackdown®	50/45	777 Powder 2F	100 gr. VU Max.	1300
290 gr. Smackdown®	50/45	Pyrodex RS	80 gr. VU Min.	1280
290 gr. Smackdown®	50/45	Pyrodex RS	100 gr. VU Max.	1425

Note: Velocities listed are from use with the Smackdown® Carnivore™ Bullet in 250 grain and the Smackdown® MZX™ Bullet in 290 grain. The velocities are approximate and for reference only.

Recommended Loads for Conicals

 **WARNING: DO NOT USE CONICALS HEAVIER THAN 370 GRAINS.**

 **WARNING: WHEN USING CONICAL BULLETS, DO NOT EXCEED 100 GRAINS OF POWDER.**

 **WARNING: POWDER CHARGES MEASURED IN VOLUMETRIC UNITS, NOT BY WEIGHT.**

Bullet Weight	Bullet Dia.	Powder	Powder Charge	Velocity FPS
370 Grain Maxi Ball	50	777 Powder 2F	80 gr. VU Min.	1200
370 Grain Maxi Ball	50	777 Powder 2F	100 gr. VU Max.	1400
370 Grain Maxi Ball	50	Pyrodex RS	80 gr. VU Min.	1200
370 Grain Maxi Ball	50	Pyrodex RS	100 gr. VU Max.	1375

Note: Velocities listed are from use with a 370 grain conical. The velocities are approximate and for reference only.

22. SCOPE MOUNTING & SIGHTING IN

The Traditions® ShedHorn™ comes drilled and tapped for easy installation of mounts and a scope and may come with a scope already mounted depending on the model.

 WARNING: DO NOT DRILL EXTRA HOLES IN YOUR BARREL. This can cause weakening of the barrel and the possibility of the barrel rupturing and/or bursting, resulting in injury or death to you or others.

Traditions® recommends using Traditions® scope bases and rings for mounting your scope as they are designed for your firearm. If you need to purchase new mounts and rings you can do so at your local dealer or on www.traditionsfirearms.com. Please contact Traditions® Customer Service Department with any questions about proper mounts and rings for your firearm.

Securing Scope Bases to Your Barrel & Tightening Scope Rings

When securing a scope base to your ShedHorn™ be sure to follow the instructions and torque specifications from the base manufacturer. The torque specs for a Traditions® one piece base is 18 lbs. Overtightening the screws can cause stripped threads and/or bent and distorted mounts. Using non-permanent Loctite® and other threading compounds is encouraged but not a requirement. When mounting the scope rings, be sure to follow the instructions and torque specifications from the base manufacturer. The torque specs for Traditions® Ring base is 25 lbs and the ring top mount screw is 15 lbs.

Mounting Your Scope

Traditions® offers a wide variety of scopes and mounting options to suit many needs. Visit www.traditionsfirearms.com to see our full line of optics and mounts or visit a dealer near you.

When mounting your scope, please take precaution in ensuring that your front objective lens bell is not touching the firearm and that your eyepiece has clearance from your hammer or cocking mechanism.

 WARNING: MAKE SURE THAT YOUR EYE RELIEF IS SUCH THAT YOU HAVE A COMFORTABLE AIMING POSITION BUT THAT YOU HAVE AN APPROPRIATE DISTANCE FROM YOUR EYE SO THAT YOU ARE NOT STRUCK BY THE SCOPE UNDER RECOIL WHILE SHOOTING.

Rifle Scope Adjustment

Rifle scopes have two turrets of adjustment for adjusting the point-of-aim for the shooter. Adjustment for elevation is on the top of the scope and windage is typically found on the right-hand side of the scope when mounted on the ShedHorn™.

 WARNING: ALWAYS FOLLOW SCOPE MANUFACTURER'S MOUNTING INFORMATION AND DIRECTIONS.

Bore Sighting The ShedHorn™

1. Check to ensure the barrel is unloaded and has no obstructions.
2. Remove your barrel from the firearm and carefully place it with the mounted scope on a sandbag or shooting vise.
3. Looking down the bore from the breech side, move your barrel to where the center of your target is in the middle of the field of vision.
NOTE: You can use a bore sighter for this process as well.

Sighting-In Your Firearm

1. Once bore-sighted, install your barrel back on your firearm. Place the firearm on your sandbag or shooting vise and fire a minimum of two shots at the bullseye.

2. Without moving the firearm, observe your shot group and its relation to the bullseye (or point of aim.)

3. Carefully adjust your scope's crosshairs with the turrets to the center of the shot group. Most hunting scopes adjust 1/4 inch per click at 100 yards. 50 yards is 1/8" and 200 yards is 1/2" per click.

4. Once your scope is adjusted to the point of impact, carefully move your firearm back to the bullseye as the point of aim.
5. Fire another shot group to determine if the point of impact is in alignment with your aim.
6. If you wish to zero at a greater distance, consult ballistic data for the load you are firing and repeat this process at that given distance.

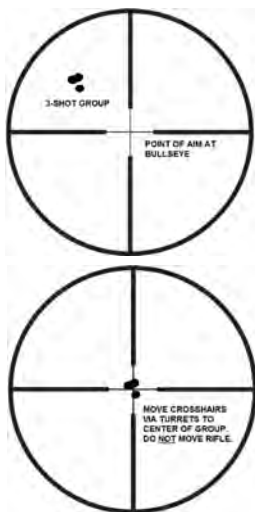

23. ADJUSTABLE SIGHTS **& SIGHTING IN**

If your firearm comes with sights or you install them, you'll want to start sighting in at approximately 25 yards with a large target. You want to achieve a grouping of shots no matter where on the target first. After you are able to shoot at least 3 shots in the same 2" area, then adjust your sight to the center bullseye.

To adjust: Move the rear sight in the direction you want the bullet to go.

Note: Take care not to over-tighten the screws or damage to the rear sight may occur.

POLYMER REAR SIGHT ADJUSTMENT

1. To adjust for elevation, loosen the screw found on the right side of the rear sight. To raise the bullet's point of impact, slide the upper portion of the sight forward (up the ramp). To lower the bullet's point of impact, slide the sight to the rear (down the ramp). Tighten the screw to lock sight in place.
2. To adjust for windage, loosen the small screw found on the top of the rear sight and just forward of the "V" notch. Slide the "V" notch to the left to move the bullet's impact point left, or to the right to move the bullet's impact point to the right. Tighten the screw to lock into place.

SCREW ADJUSTABLE REAR SIGHTS

1. To adjust for elevation, turn the large screw in the center of the sight.
2. To adjust for windage, turn the screw located on the right side of the sight. Turn the screw clockwise or counterclockwise to move the point of impact right or left, respectively.

FIXED REAR SIGHTS

1. The windage adjustment can be accomplished by tapping the rear sight in its dovetail with a small piece of wood. Moving the sight to the left, moves the point of impact to the left.
2. Elevation adjustment can be accomplished by filing off the top of the front sight to move the point of impact higher or deepening the slot in the rear sight to move it lower.

Note: Traditions® recommends while sighting in your ShedHorn™ that you clean the bore between each of your shots. By doing this you are starting out with a fresh, seasoned bore that will help prevent some shooting errors such as powder build up that could cause poor accuracy. Different projectiles and recommended powder charges can vary in accuracy, so make sure to sight in using the same projectiles and powder charges first and then change if needed.

24. WARRANTY & SERVICE

LIMITED LIFETIME MECHANICAL WARRANTY

Traditions® will warrant this firearm to be free of mechanical defects in materials or craftsmanship for the life of the firearm while in the possession of the original owner except composite stocks, wood stocks, and finishes. Traditions® will repair or replace, at its own option, product or parts which are returned at owner's expense to the Traditions® Customer Service Department. Call 860-388-4656 to obtain a factory issued Return Merchandise Authorization number. A full explanation of the specific problem must be given to the customer service representative.

This warranty shall remain in force unless any of the following are determined by the Traditions® Customer Service Department:

1. Normal wear from regular and intended use.
2. Use of any propellant other than black powder or approved black powder substitutes.
3. Use of any powder charge in excess of those recommended in this booklet or by the powder manufacturer.
4. Use of any plastic patching material with round balls.
5. Modification of internal parts as they were shipped from the factory.
6. A lack of proper maintenance and thorough cleaning is evident such as rust.
7. Peeling of camo finish after 1 year of service.
8. Failure to comply with the instructions listed here in the owner's manual.
9. Customer abuse.

Traditions® specifically disclaims any and all warranties other than those listed above on this page to the fullest extent allowed under applicable law, including warranties of merchantability and/or fitness for a particular purpose. This warranty applies only to the firearm. It does not apply to any accessories.

NOTE: Proof of purchase is required to show original ownership for all warranty work.

PLEASE HELP US SERVE YOU BETTER

In the event you should have questions pertaining to the function or performance of your new Traditions® firearm please visit our website to get answers to the most commonly asked questions. Log on to www.traditionsfirearms.com where you will find the FAQ page. This page will get you fast access to trouble shooting solutions. If you do not find an answer to your specific question on the FAQ page of our website please feel free to email info@traditionsfirearms.com and a qualified member of our team will respond to your individual question as quickly as possible. Additionally, there are numerous videos on our website that can help answer questions regarding your firearm. Visit www.traditionsfirearms.com/video-listings or <https://www.youtube.com/user/TraditionsFirearmsOfficial>.

In the event you still need assistance please do not hesitate to contact Traditions®, and a member of our Customer Service Department will be happy to assist.

In the unlikely event you need warranty service on your firearm we need your help to get the work done right and without delay. It is simple to send an email or give us a call to discuss the issue.

Traditions® conveniently engraves the caliber, serial number and model name on each firearm. Take note of this information, record it on the warranty page in this manual and be prepared to state it when contacting the Traditions® Customer Service Department with your questions.

Steps to Return a Firearm for Service

1. Do not return your firearm to the dealer.
2. Please call us and describe the problem. Chances are we can either guide you to a solution right over the phone or when possible send you the parts you need to correct the problem. Should your firearm need factory service, we will give you instructions about where to ship it and issue you a Return Merchandise Authorization number.
3. All firearms must have a factory issued Return Merchandise Authorization number (RMA) before returning to Traditions® for warranty service. Firearms without an RMA number will be refusedž

4. Package your uncharged firearm safely and securely inside a sturdy box. The Traditions® box your firearm arrived in is NOT a shipping box. **NOTE: Firearms packaged and shipped improperly are not covered under warranty if damage occurs.**
5. Write your RMA # on the outside of the box so it can be easily seen when it arrives at our facility.
6. Ship your uncharged firearm to:
Traditions®
1375 Boston Post Rd. • P.O. Box 776
Old Saybrook, CT 06475-0776

 **WARNING:** It is in violation of Federal Law to ship a charged firearm. If your firearm has a live charge and/or projectile in the barrel, please take it to a local gunsmith for removal or call Traditions® Customer Service Department at 860-388-4656.

 **ATTENTION:** YOUR FIREARM MUST BE CLEANED BEFORE IT CAN BE INSPECTED. If we need to clean your firearm in order to inspect it there will be a standard cleaning, lubrication, inspection, and function test (C.L.I.F.) service fee.

NOTE ON ACCESSORIES:

Please remove all after-market accessories from your firearm prior to sending it in for repairs. This will ensure that these items will not be lost, misplaced, or damaged during the return process.

TRADITIONS® WILL NOT BE HELD LIABLE FOR ANY AFTER-MARKET ITEMS OR ACCESSORIES THAT ARE LOST OR DAMAGED IF THEY ARE NOT REMOVED AND ARE SENT IN ON YOUR TRADITIONS® ITEM COMING BACK FOR REPAIR.

FOR YOUR RECORDS

Important: Please record information here and keep for your record.

Model No. _____

Serial No. _____

Model Name _____

Caliber _____

Date Purchased _____

From _____

Registration Card mailed on _____

Please call Traditions® Customer Service Department at 860-388-4656 with any questions or concerns.

To register your warranty online please go to www.traditionsfirearms.com/support/warranty-registration or you can mail in the warranty card in this manual.

To be added to our email list for announcements, specials, and other information please visit our website at: www.traditionsfirearms.com.

PREFERRED CUSTOMER WARRANTY REGISTRATION CARD

To submit your warranty registration online, visit
www.traditionsfirearms.com/support/warranty-registration



Referencing the label on the end of the carton, please write in the last 5 digits located on the right half of the UPC code into the boxes below.

UPC #

4	0	5	8	9	-					
---	---	---	---	---	---	--	--	--	--	--

Model# _____

Serial# (from barrel) _____

Name _____ Age _____

Street _____

City _____ State _____ Zip _____

Day Time Phone # _____ Date of Purchase _____

Purchase Price _____ Store Name _____

1. What is your age? Under 18 18-24 25-34 35-44 45-54 55-64 over 65

2. Reason for your purchase Hunting Target Shooting Personal use Gift
 Raffle Prize Other

3. Do you own? Muzzleloaders Over/Under Shotgun Side by Side Shotgun
 Semi-Auto Shotgun Pump Shotgun Cartridge Rifle Handgun Bow

4. Where purchased? Gun Shop General Sporting Goods Store Hardware Store
 Chain Store Mail Order Catalog Internet Store

5. Which factors influenced your purchase? Previously owned a Traditions product
 Magazine Ad/Article Website Traditions Catalog Recommendation of Salesperson
 Recommendation of a Friend Price Features Other

6. What type of game do you hunt? Whitetail Deer Mule Deer Elk Bear
 Antelope Turkey Small Game Other

7. What do you think is the best way to get information about Hunting & Hunting products?
 Magazine Ads Internet/Website Television Programs Radio

8. Which magazine/s do you read? _____

9. Which TV hunting shows do you watch? _____

To be added to our email list to receive Traditions® emails including giveaways, product information, and more please provide your email address:

NOTE: Return this card within 15 days of purchase in order to validate your warranty.

Please complete all information above and mail to:



P.O. Box 776 • Old Saybrook, CT 06475-0776

www.traditionsfirearms.com

© 2023 Traditions® Performance Firearms. All Rights Reserved.

Cut Along Dotted Line



P.O. Box 776
Old Saybrook, CT 06475-0776

**Place
Postage Here.**
Or for additional
security enclose
in a envelope.